

TDAC4 Dacia Sandero & Logan inc Stepway Models 2020>

Item	Qty	Description	Item	Qty	Description
A	1	TDAC4 Crossbar	F	2	M16 x 50 Bolts & Nyloc Nuts
B	2	Side Arms	G	2	M12 x 40 Bolts & Nyloc Nuts
C	4	Chassis Spacers	H	1	M12 x 120 Bolt (10.9) & Nyloc Nut
D1	1	Left Hand Internal Mounting Bracket	J	4	M6 x 20 Self Tapping Bolts
D2	1	Right Hand Internal Mounting Bracket	K	4	M6 x 15 Bolts & Nyloc Nuts
E	1	Extension	L	4	M12 x 45 Bolts & Nyloc Nuts
T1	1	30 O/D x 60 mm Long Tube	M	4	M12 x 45 Bolts & S/P Washers
			N	12	6 x 20 Flat Washers
			P	12	12 x 25 Flat Washers
			Q	4	12 x 30 Flat Washers

Bumper Removal

1. Remove the rear light clusters one fixing each side.
2. Remove the two fixings in the wheel arch from each side, then remove the four fixings along the bumpers lower edge.
3. Pull bumper out sideways then rearwards to remove, unplugging any wiring looms to separate the bumper.
4. Drill out the rivets securing the internal plastic bumper reinforcement to the impact beam (Retain as this will be reinstalled later) then remove them impact beam, four fixings, (This is not reused with the Towbar assembly), then refit the fixings back into the panel.
5. Remove the tape covering the two mounting points in the chassis from each side.

Towbar Installation

1. Loosely attach items **B** to the chassis using items **M** and items **Q** with items **C**.
2. Loosely attach item **A** to items **B** using items **L** with items **P**.
3. Loosely attach items **D1** and **D2** to item **A** using items **J** and items **N**.
4. Fully tighten all the fixings ensuring the Towbar is rigid, square, and secure.
5. Loosely attach the internal plastic bumper reinforcement to items **D1** and **D2** using items **K** and items **N** as shown in **Figure 1** and mount as far to the nearside as possible and fully tighten the fixings.
6. Cut the bumper in the lower face where the pre-marked area is using **Figure 2** as a guide then remount onto the vehicle.
7. Loosely attach item **E** to item **A** using items **G** with items **P** and item **H** with items **P** ensuring item **T1** is fitted in-between the lower mounting point.
8. Using items **F** secure your desired ball bracket and wiring plate (Not supplied in this kit) to item **E**.
9. Fully tighten all the fixings ensuring the Towbar is rigid, square, and secure.

Figure 1

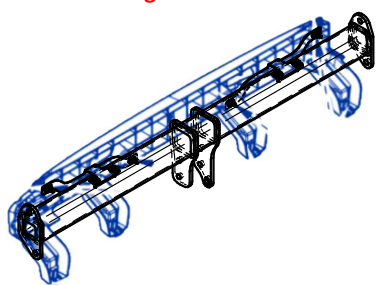
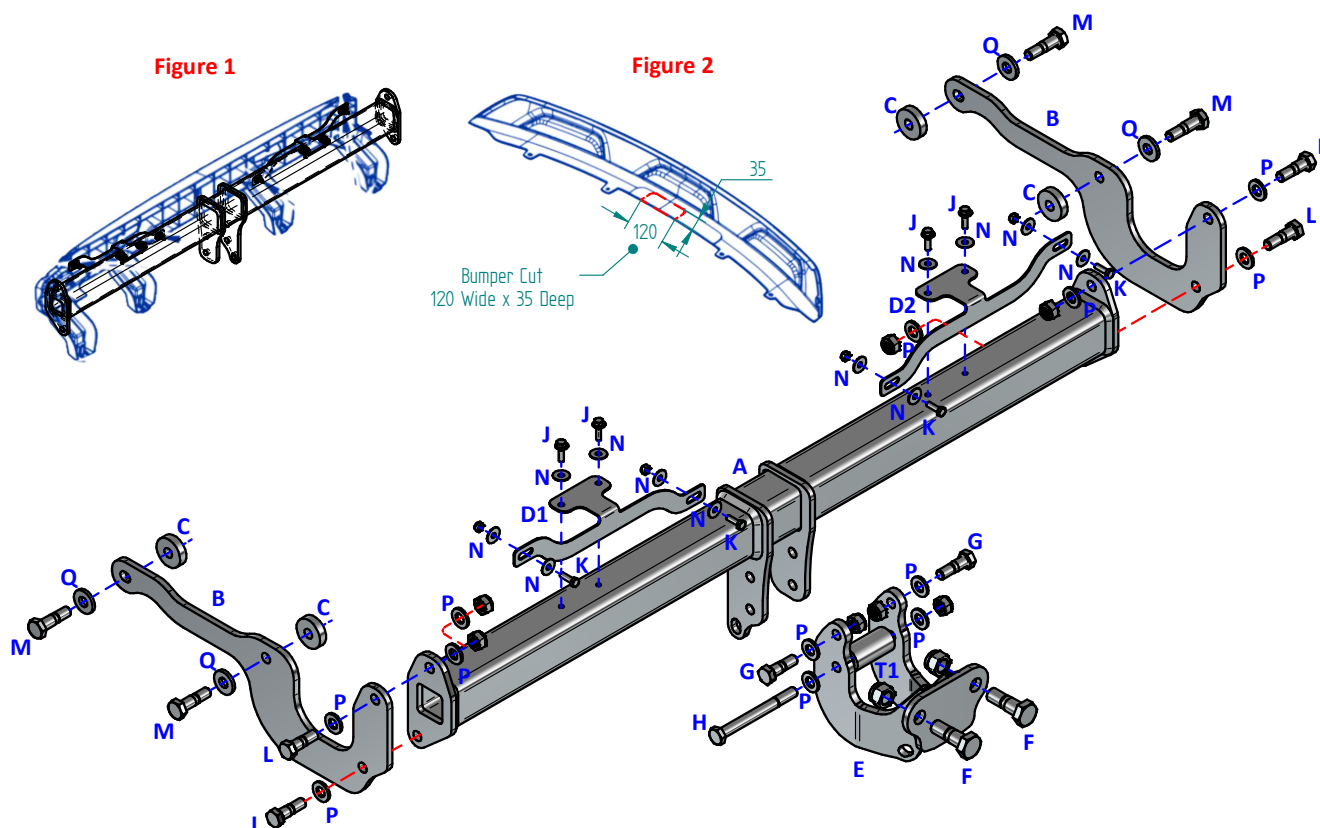
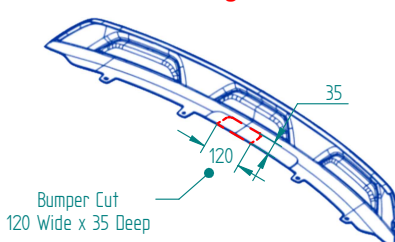

Figure 2



Notes:

1. For Torque settings see general notes overleaf.
2. Nose load limits and vehicle manufacturer's trailer / caravan weight limits must be observed.
3. We recommend the use of PRO-TOW Couplings with all our products.