

Citroën C4 Cactus 07/2014-

Partnr.: PE-065-B1U

- Fitting instructions electric wiring kit tow bar with 12-N socket up to DIN/ISO Norm 1724.
- We would expressly point out that assembly not carried out properly by a competent installer will result in cancellation of any right to damage compensation, in particular those arising by virtue of the product liability act.
- Contents of these kits and their fitting manuals are subject to alteration without notice, please ensure that these instructions are read and fully understood before commencing installation.
- Do not overload circuits; the maximum loads per connection are detailed in this manual.
- Attention! Before Installation, please read this manual carefully and inform your customer to consult the vehicle owners manual to check for any vehicle modifications required before towing.
- In the event of functional problems, troubleshooting must be limited to about 0.5 hours, contact the installers support: customercare@ecs-electronics.com / 00800 22 55 23 27.



**00800
22 55 23 27
CALL2ECS**

Monday - Friday

08.00am - 11.00am

12.00am - 05.00pm GMT

customercare@ecs-electronics.com

www.ecs-electronicsuk.co.uk

Part list

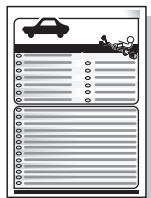
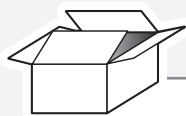

M

E

X

L1

1x

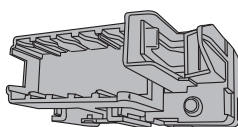

L2

1x

L2

L1

M

X

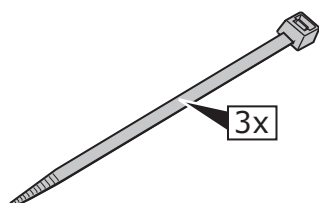
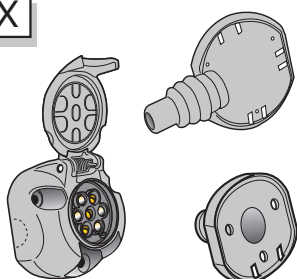

3x

UN-243-YZ

Optional reverse lamp
pre-wire extension included



Pag. 17



3x

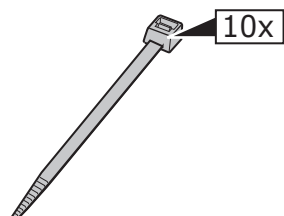

10x

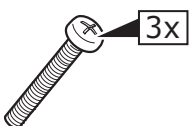

3x

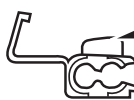

1x

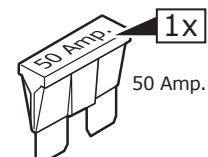

1x

50 Amp. MAXIFUSE

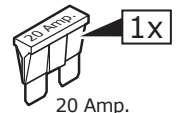

1x

20 Amp.

INFO

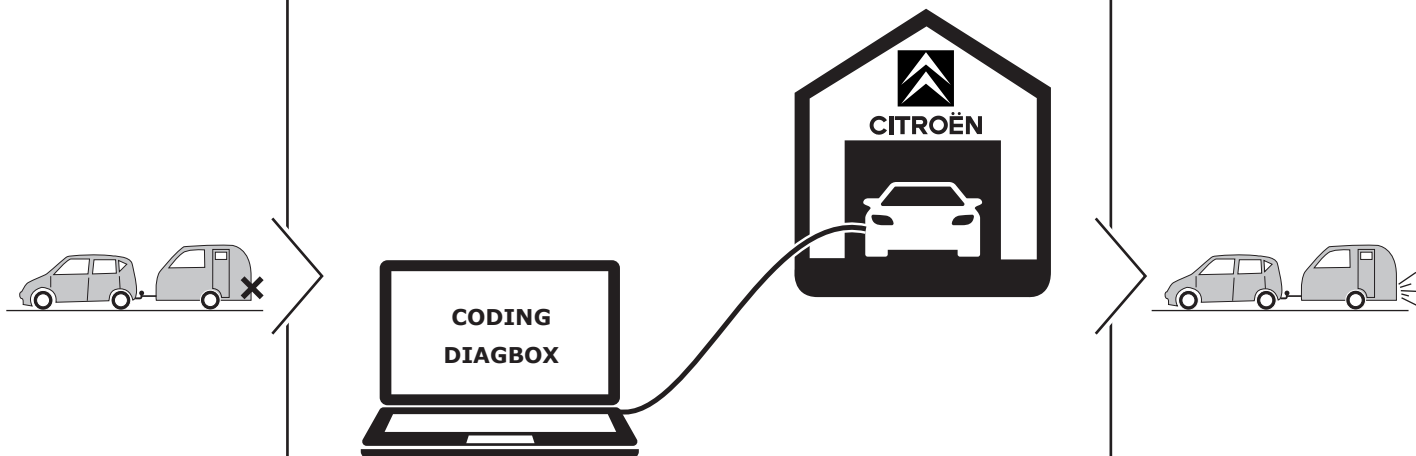

Code vehicle for lighting functions

ROUTING

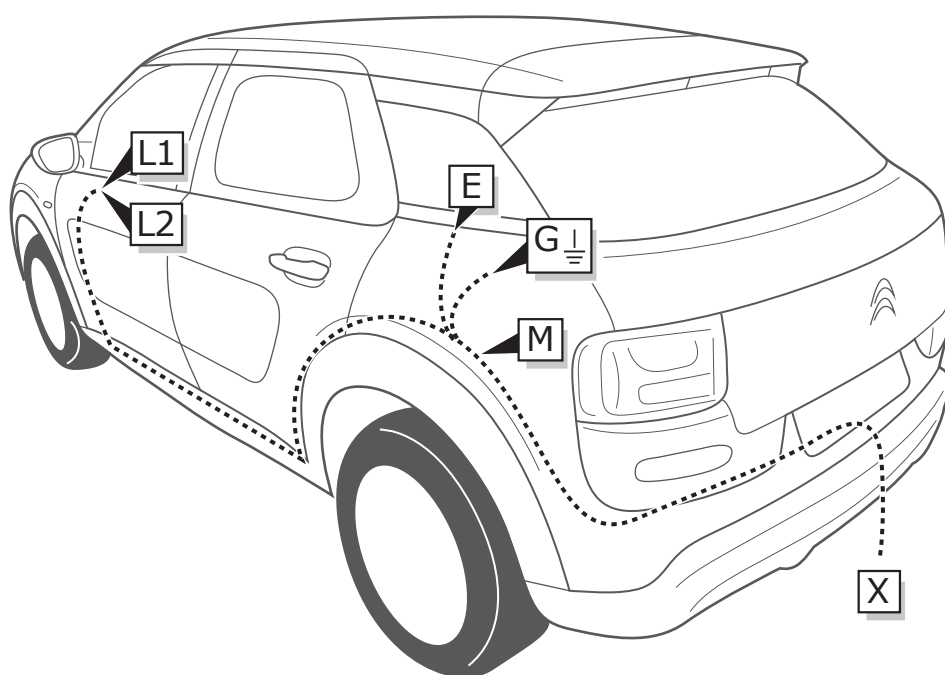

1

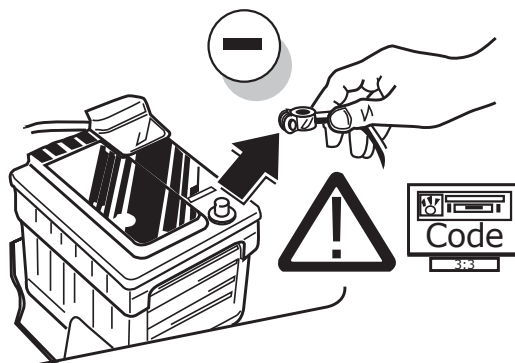

2

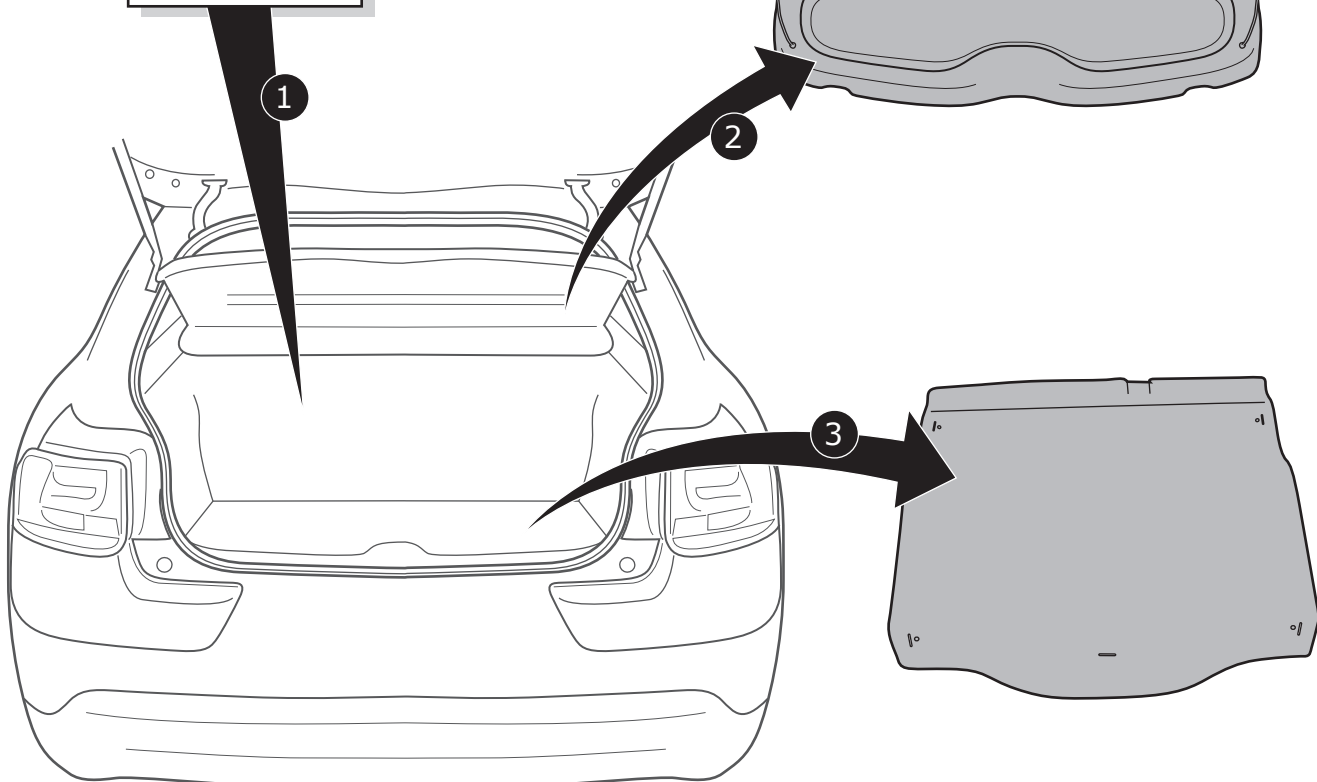
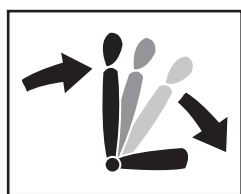

3

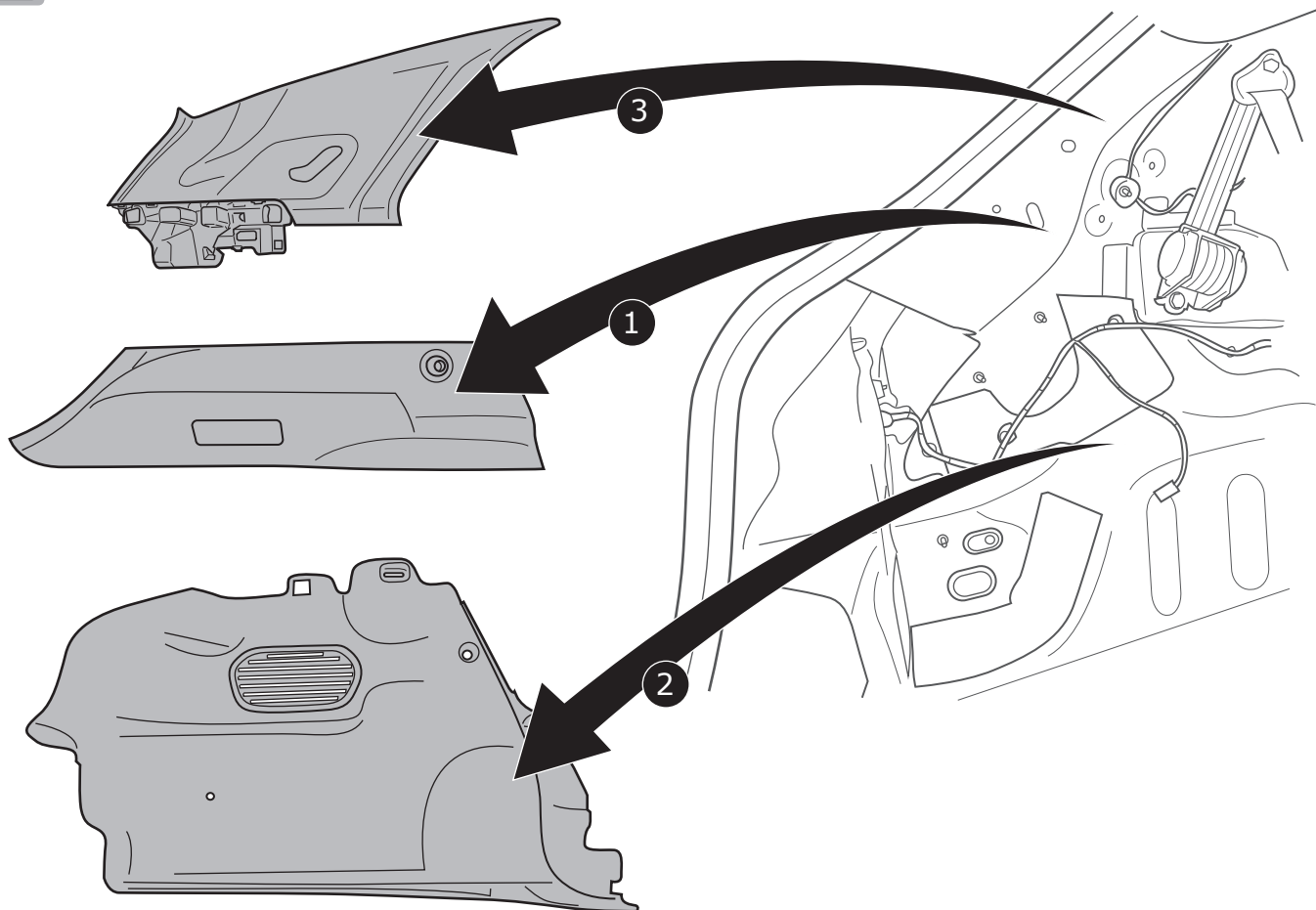

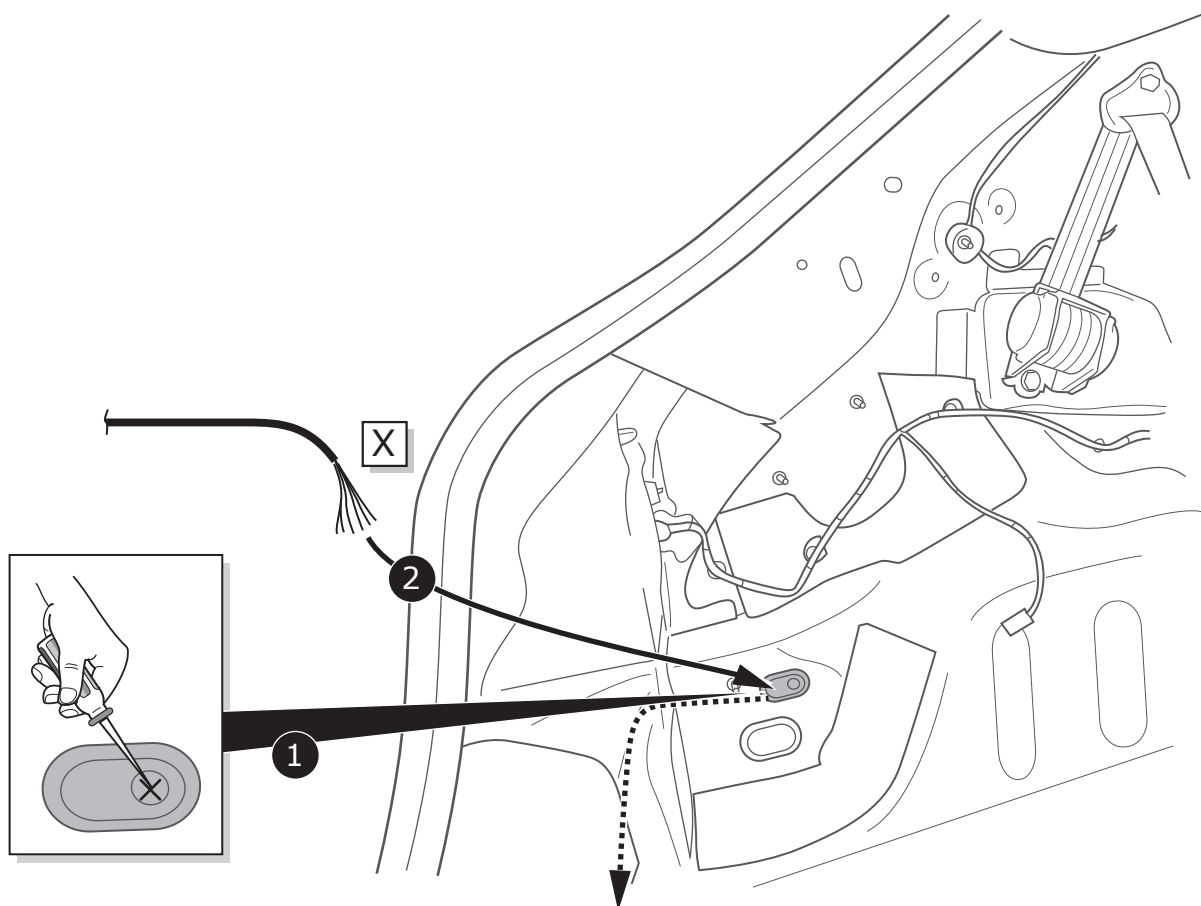

Option 1

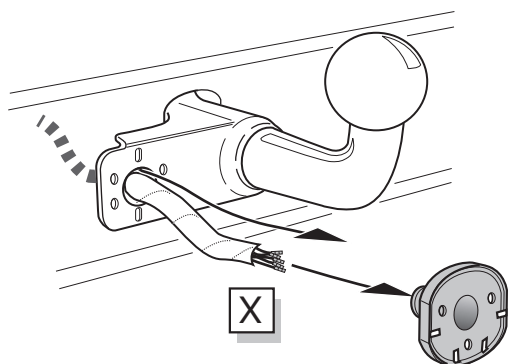

Option 2

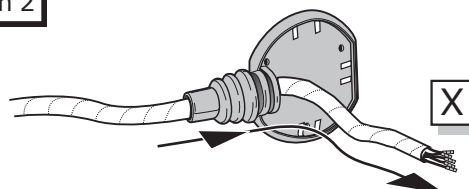

Option 3

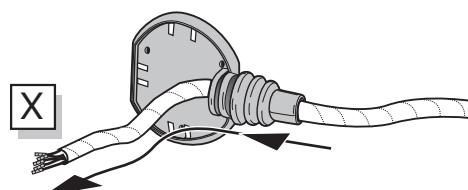

INFO

SOCKET CONNECTION



Pag. 16

B

Option 1

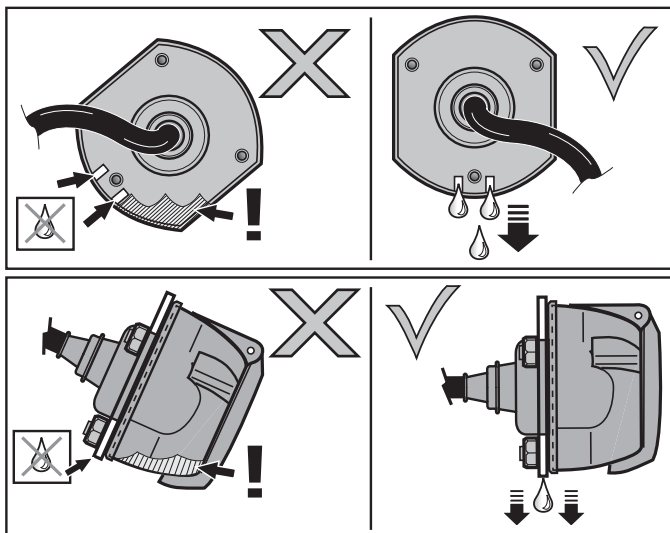
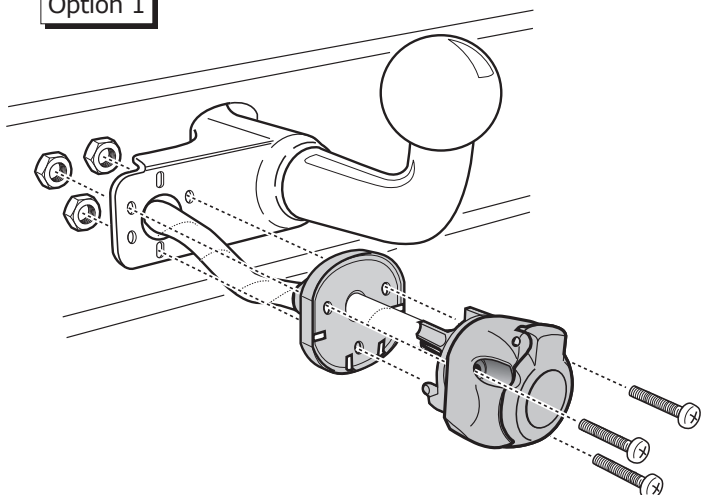
**C**

Option 2

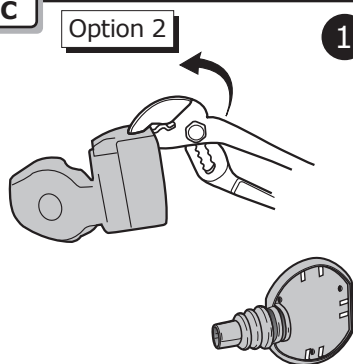

1

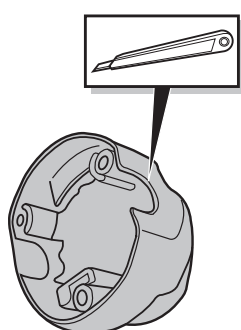

2

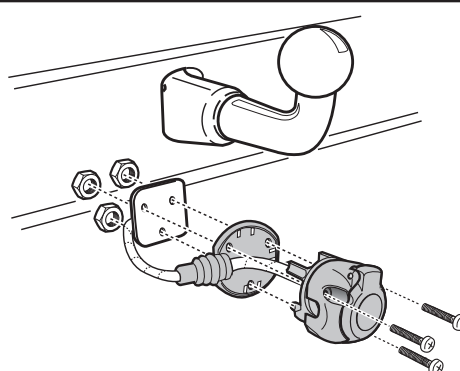

3

D

Option 3

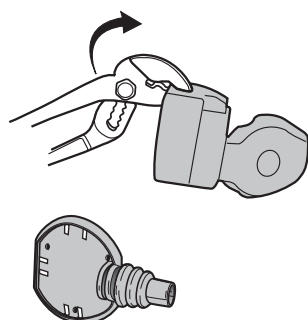

1

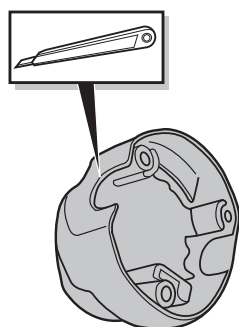

2

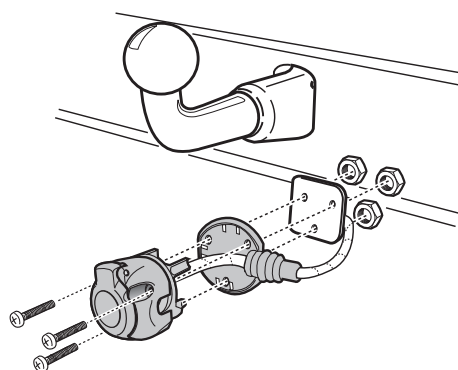

3

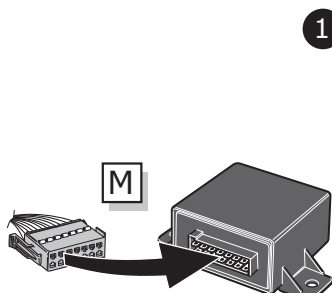
5

1

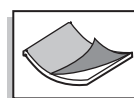

2

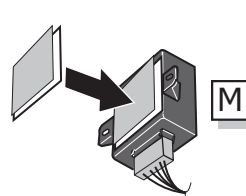

3

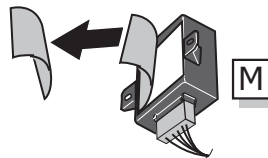

4

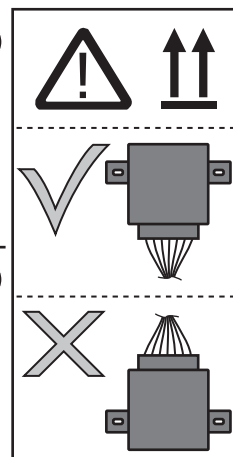

6

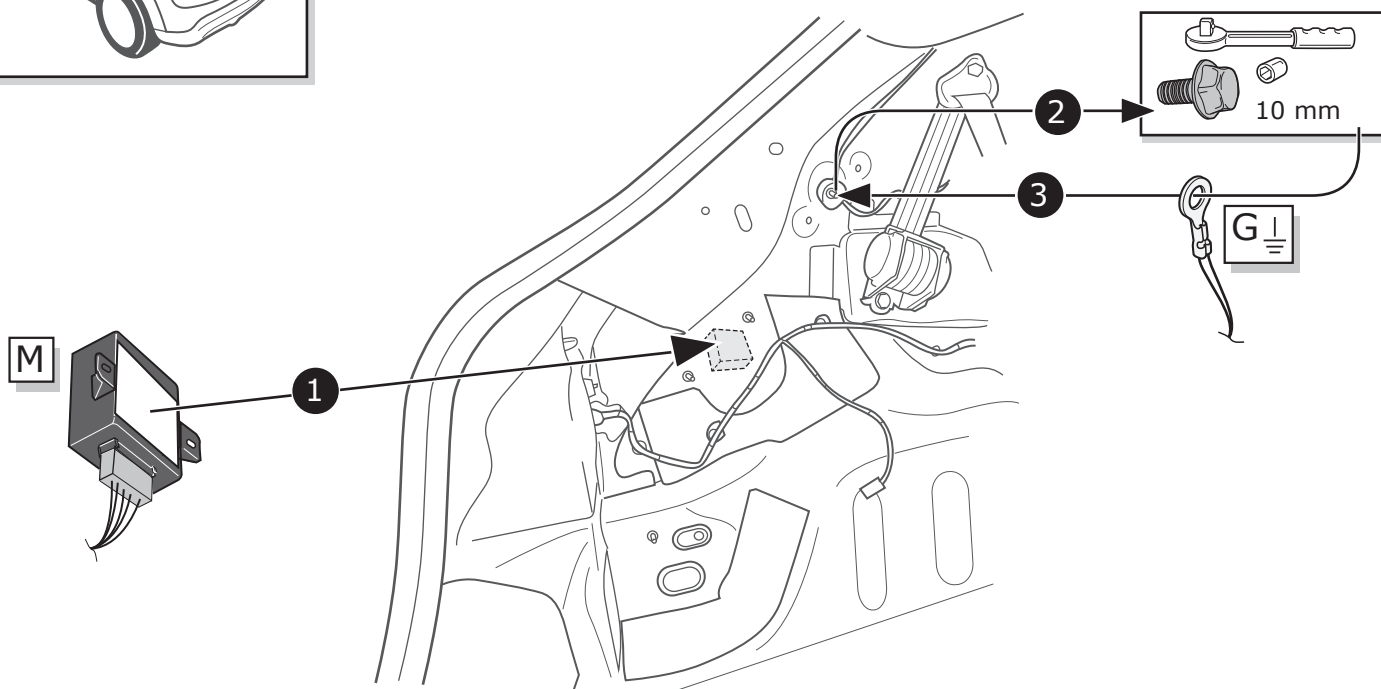
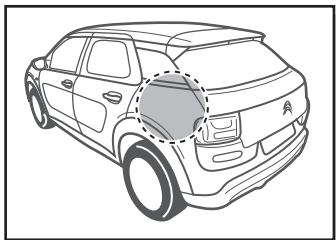

7

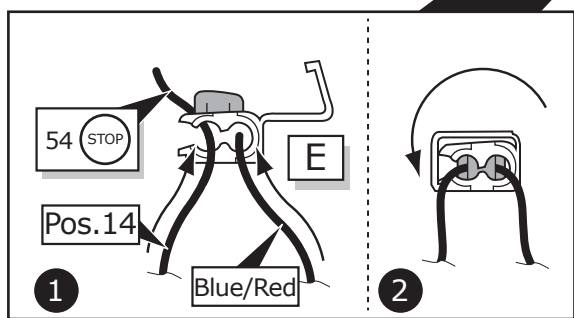
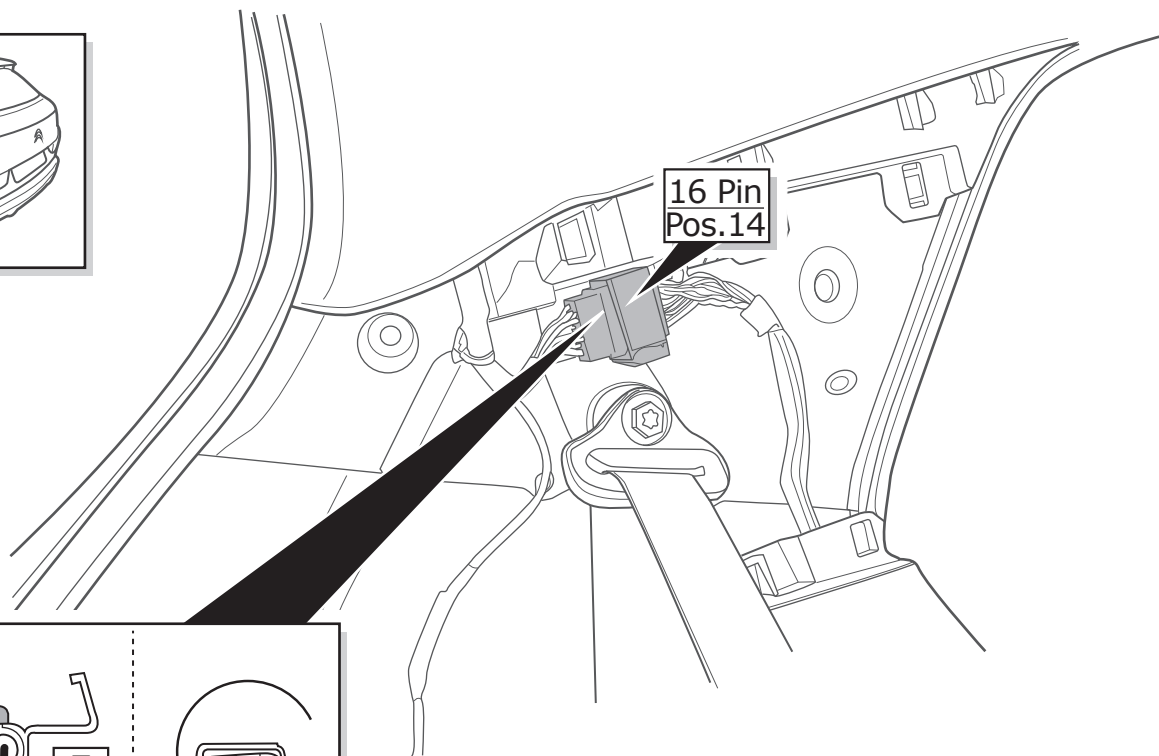
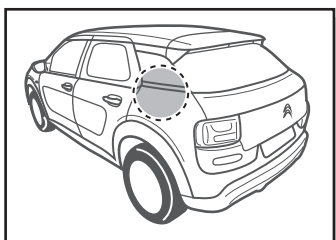

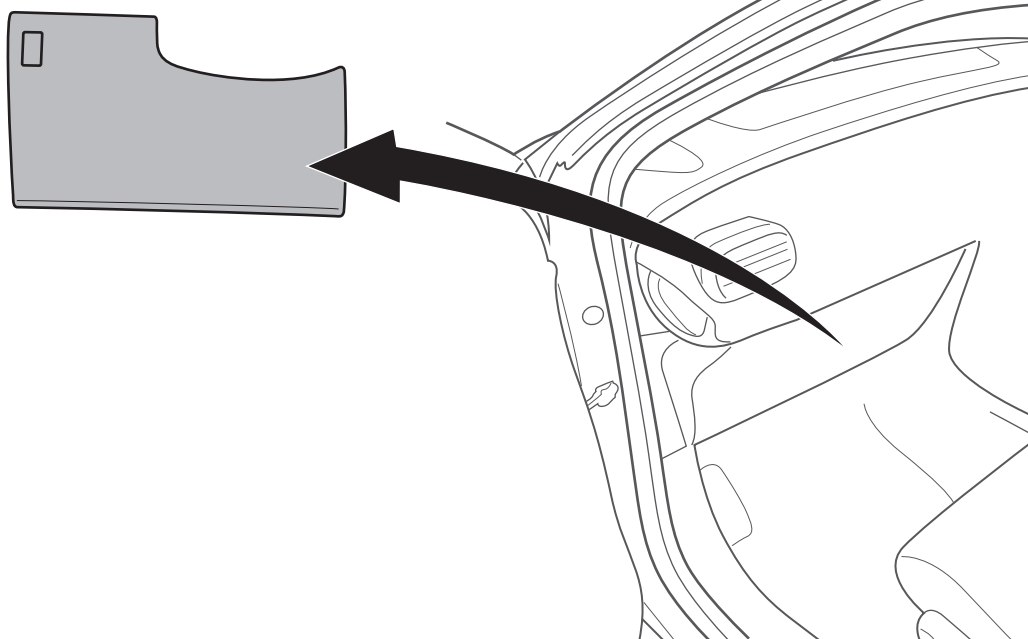
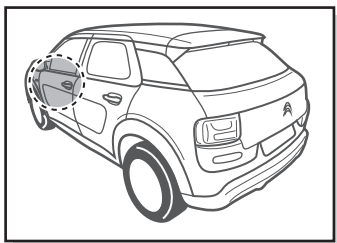
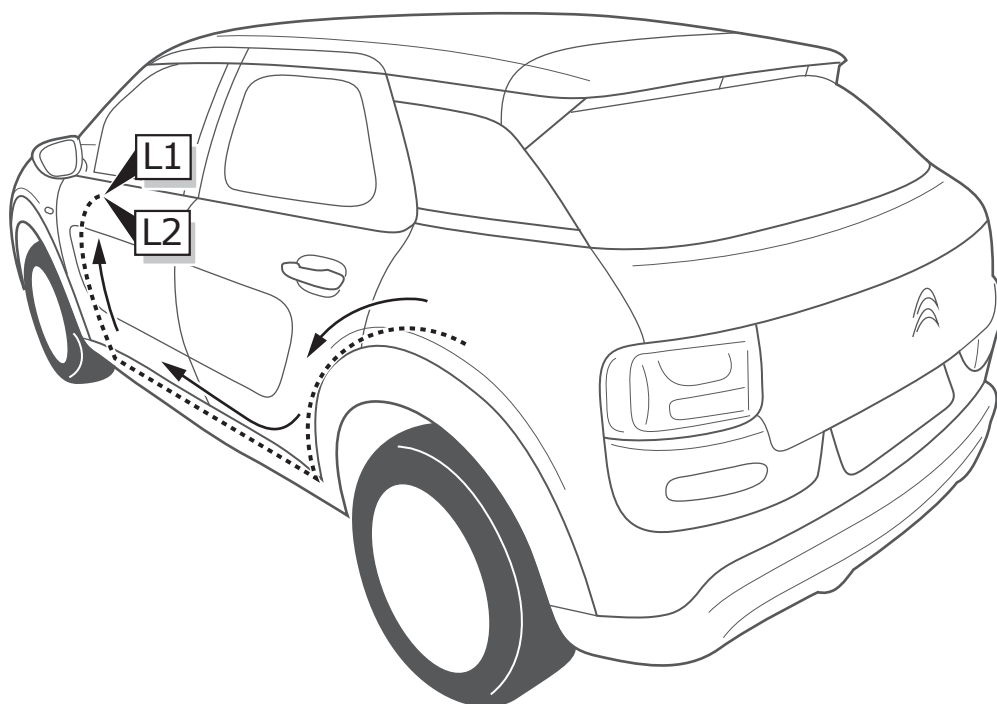

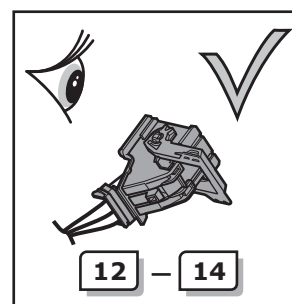
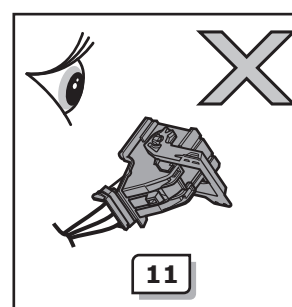
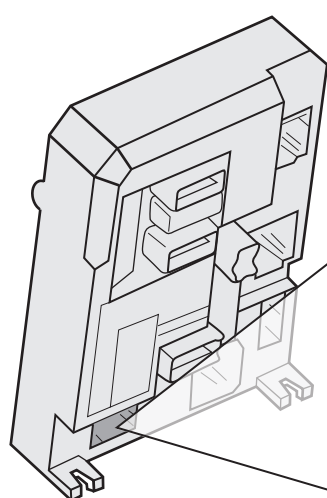
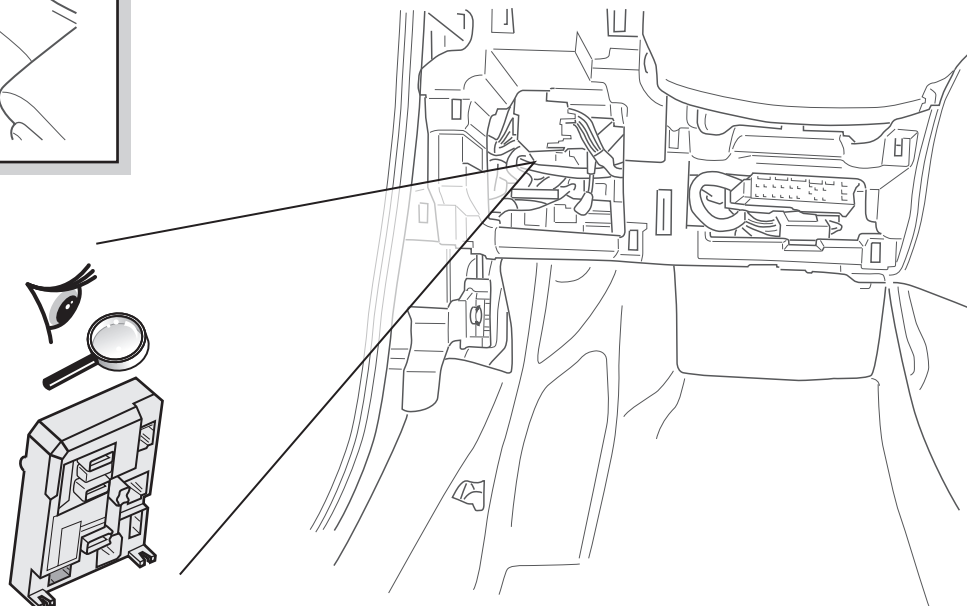
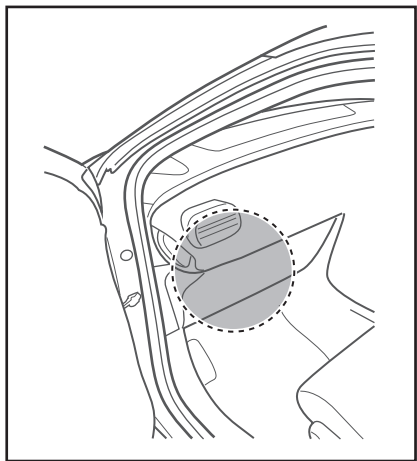

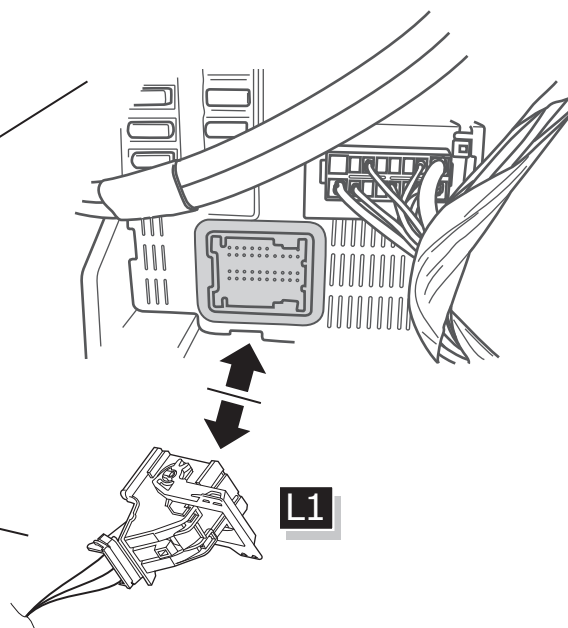
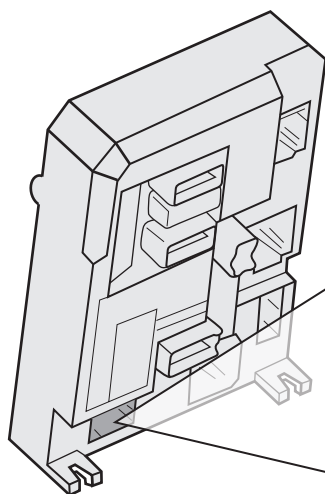
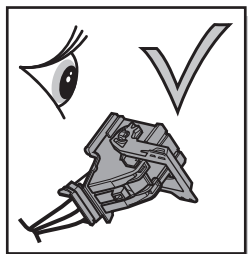
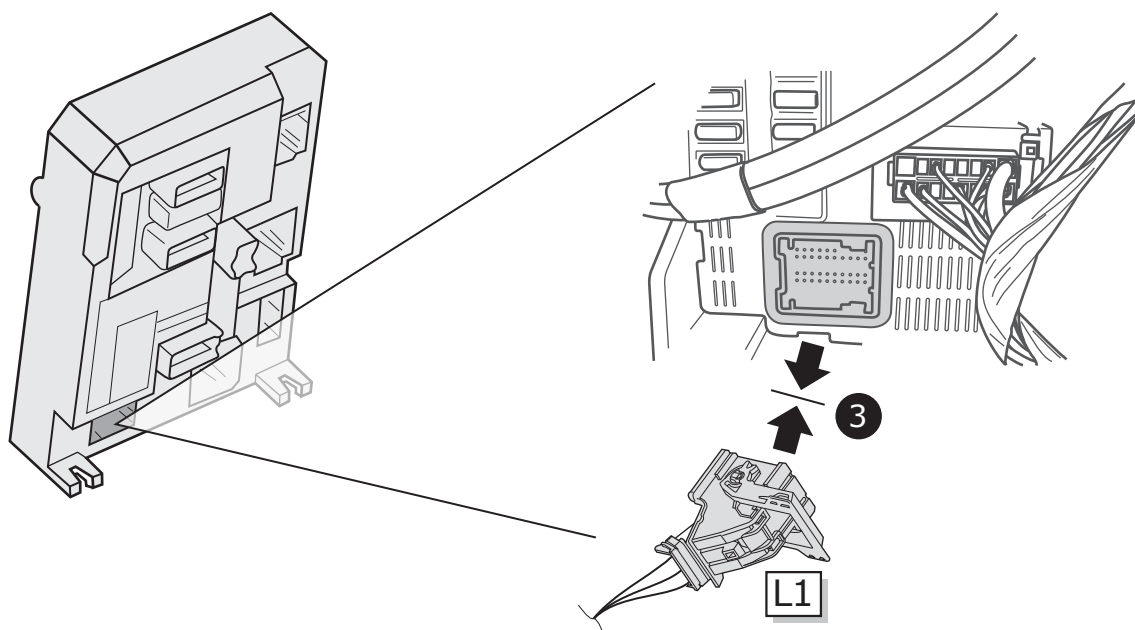
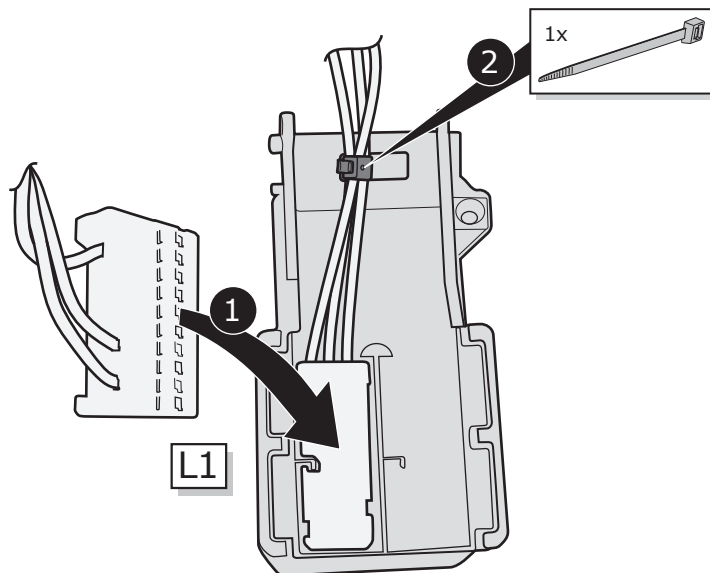
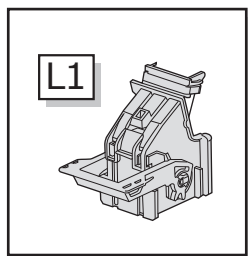
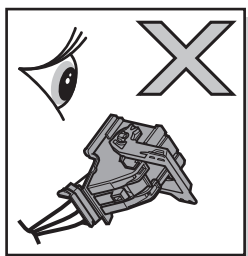

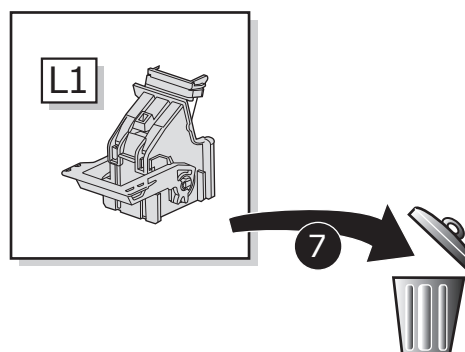
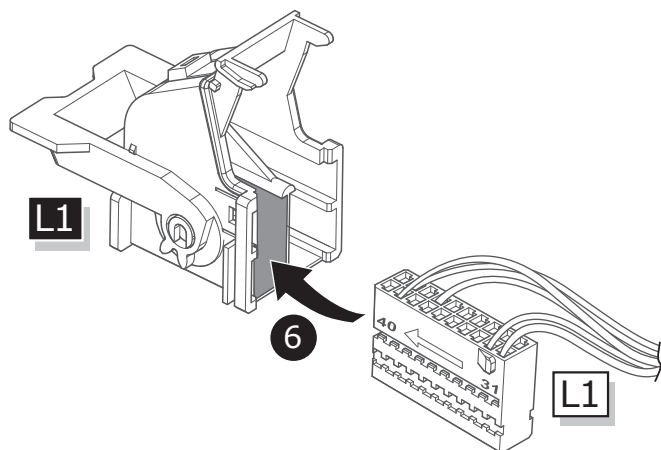
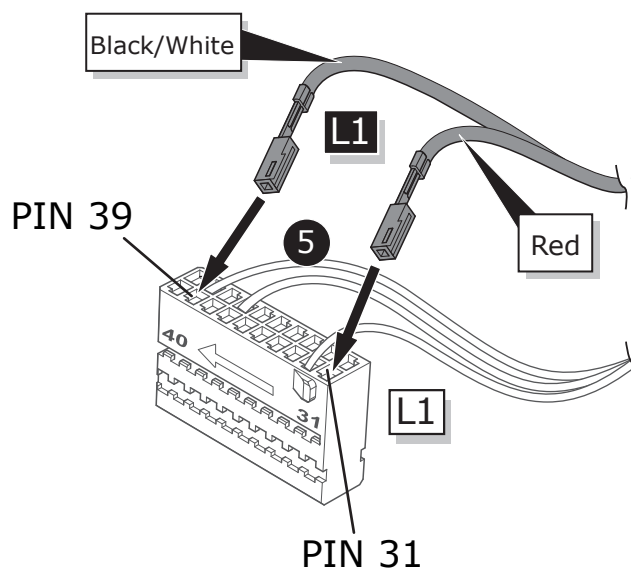
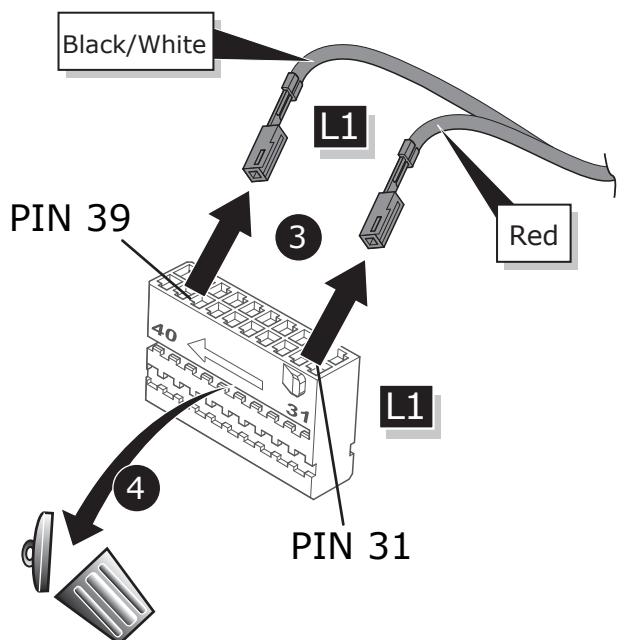
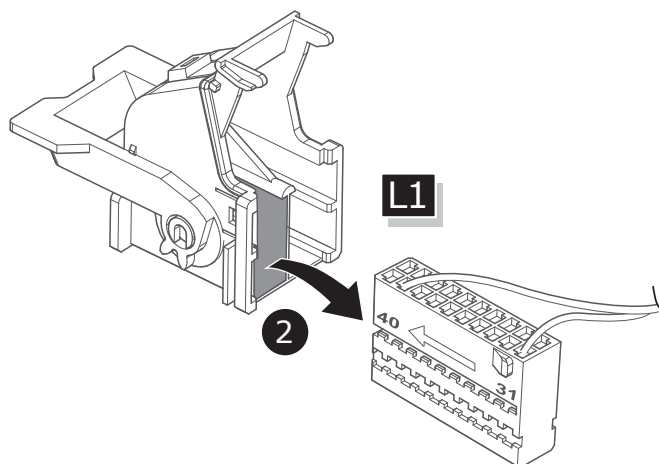
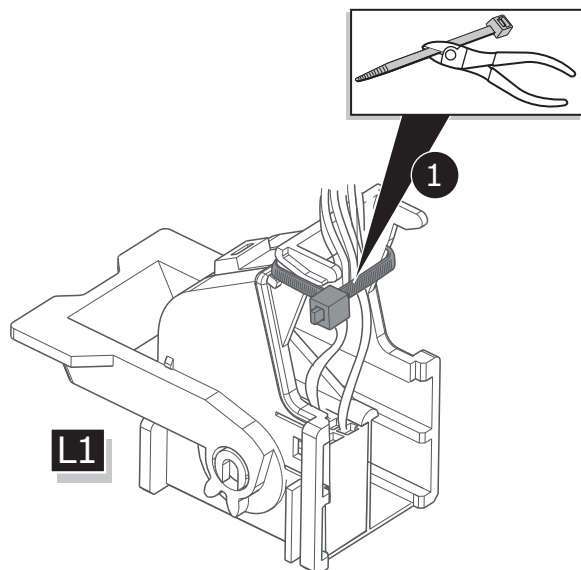

14

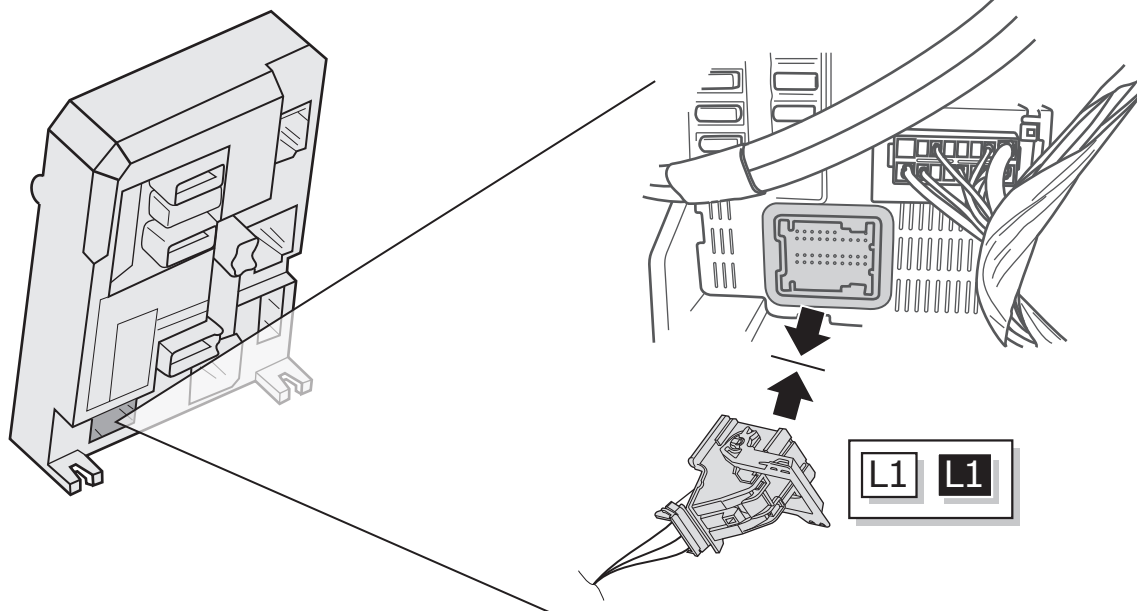

15

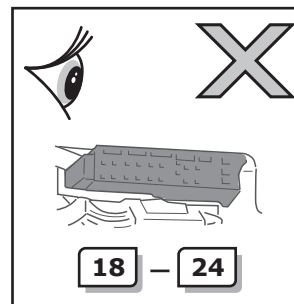
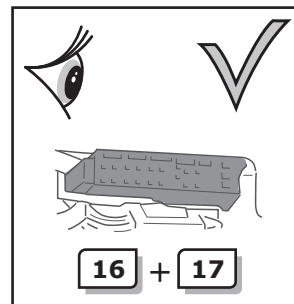
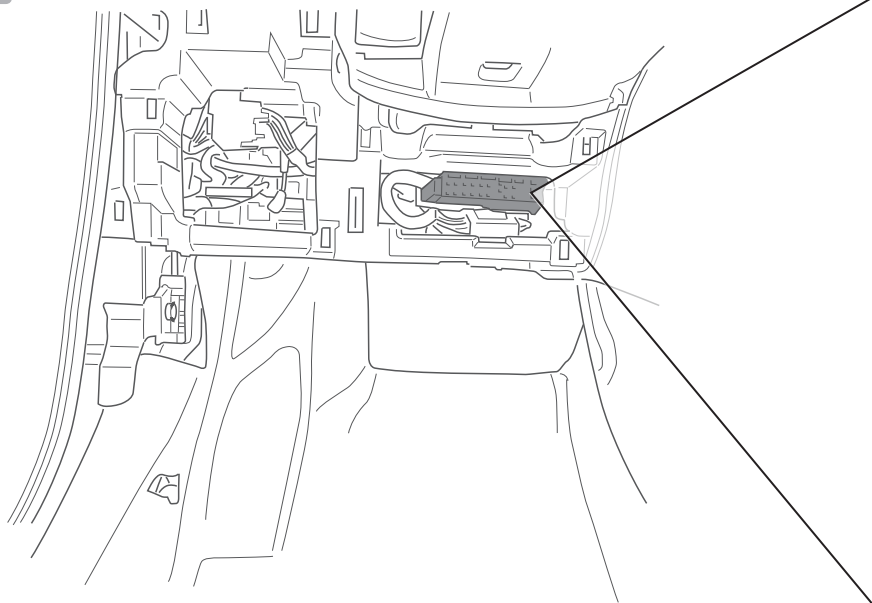

16

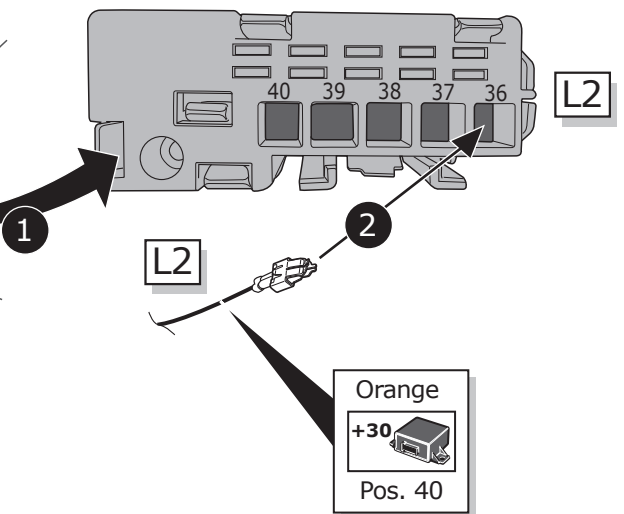
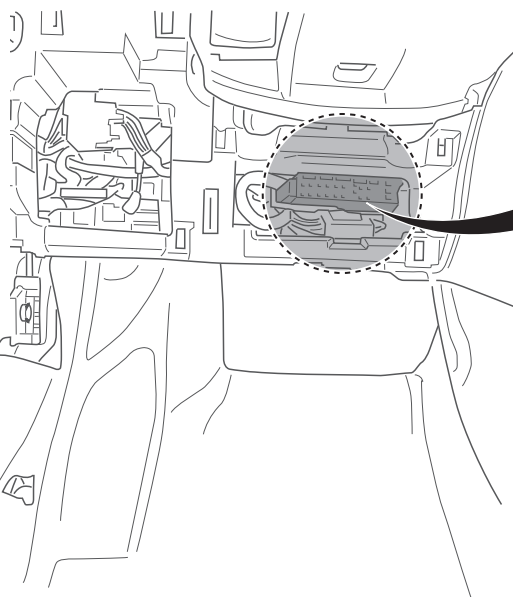
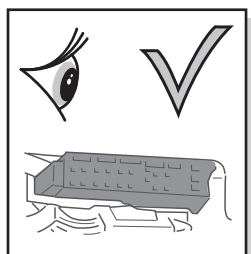

17

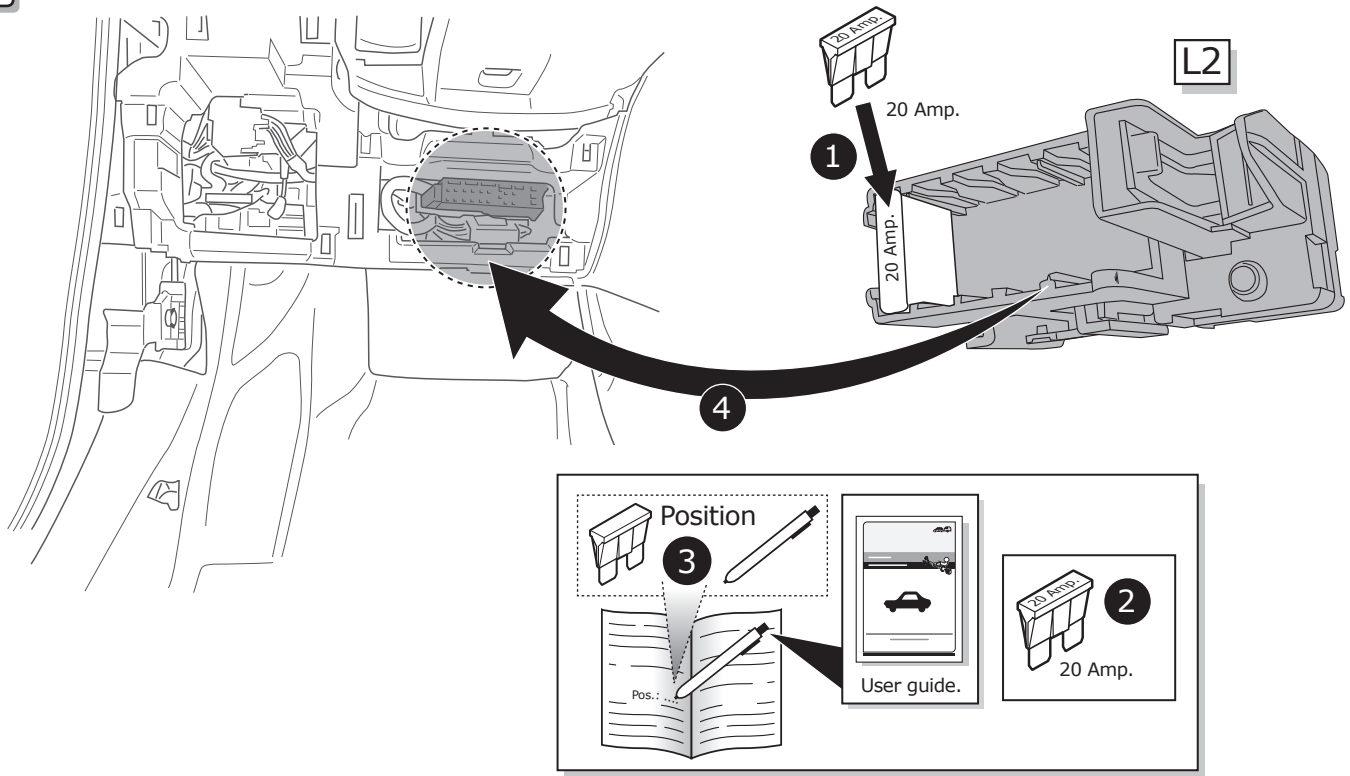

18

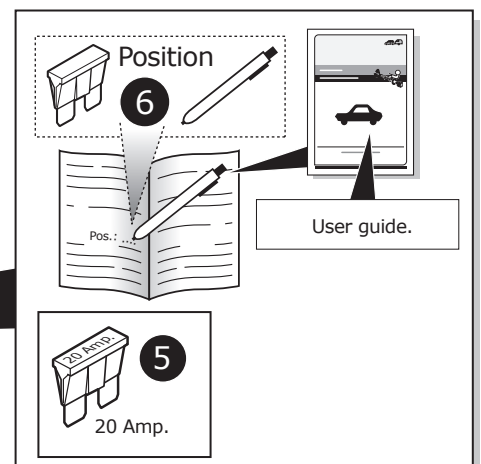
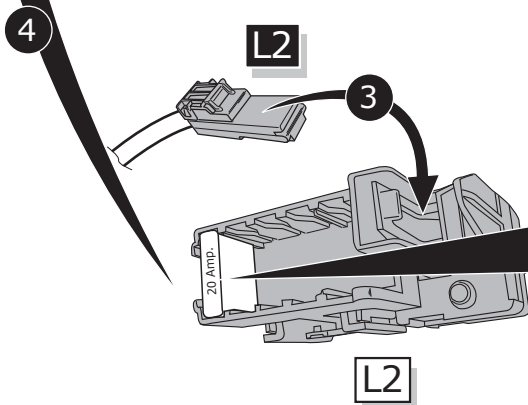
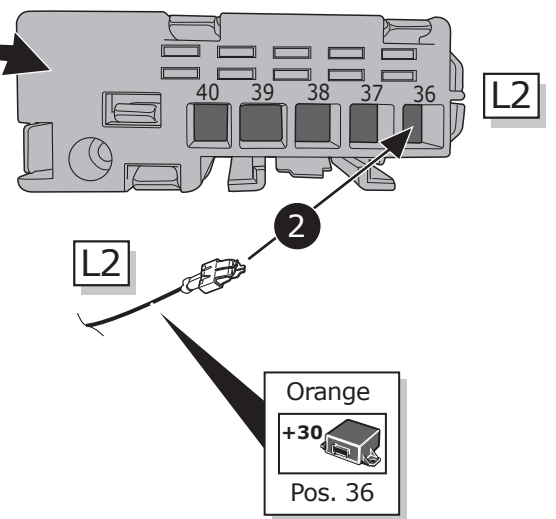
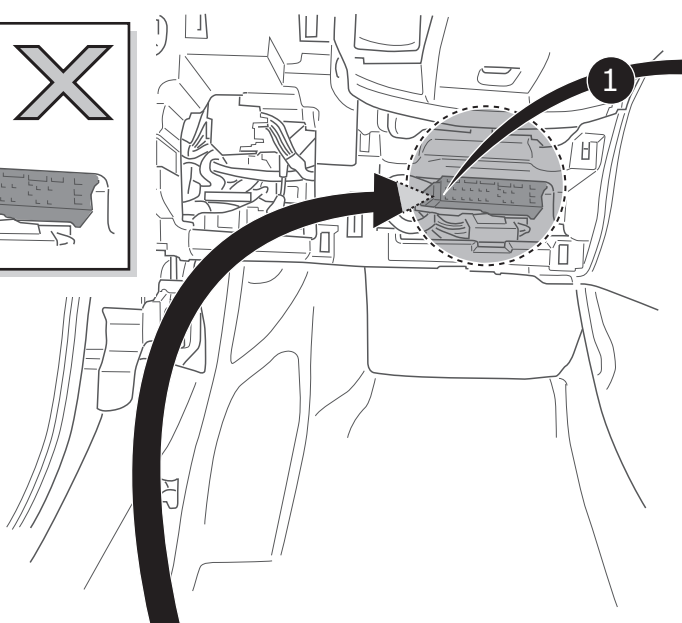
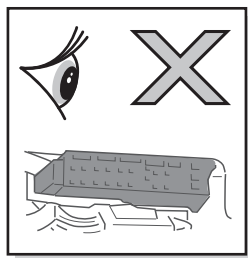

19

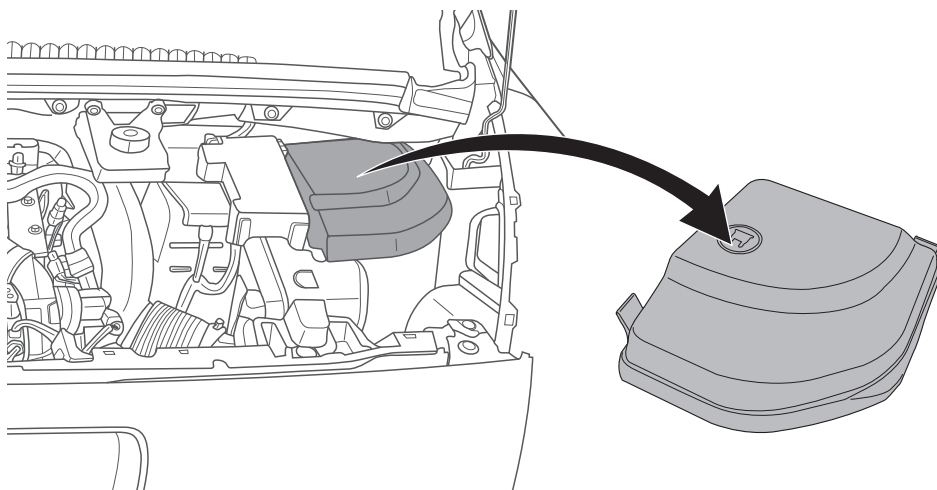
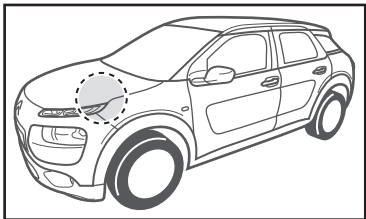

20

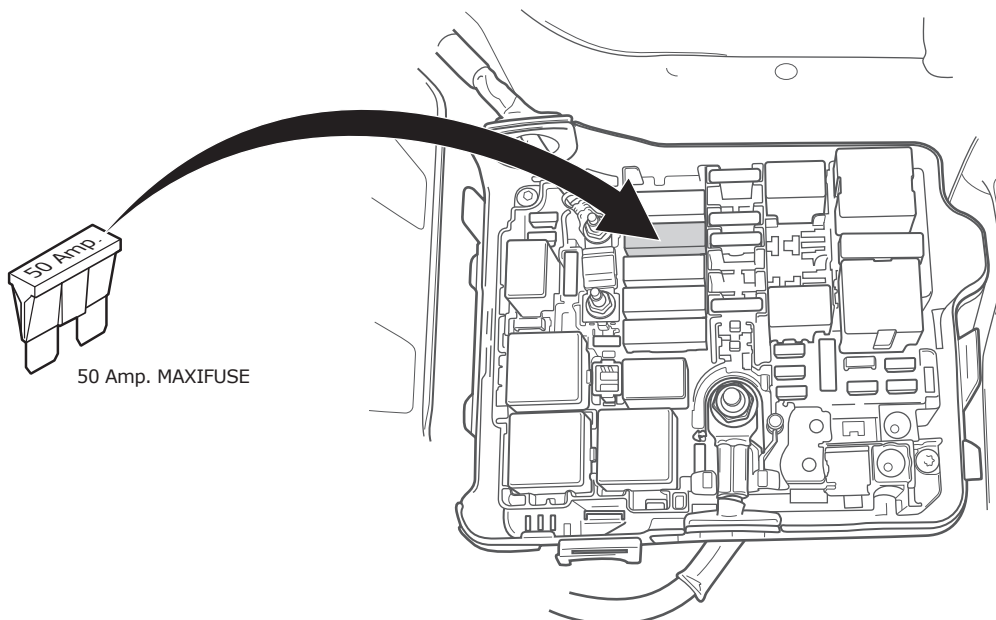

21

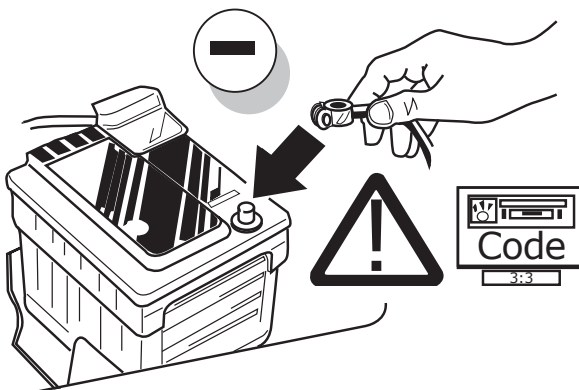

22

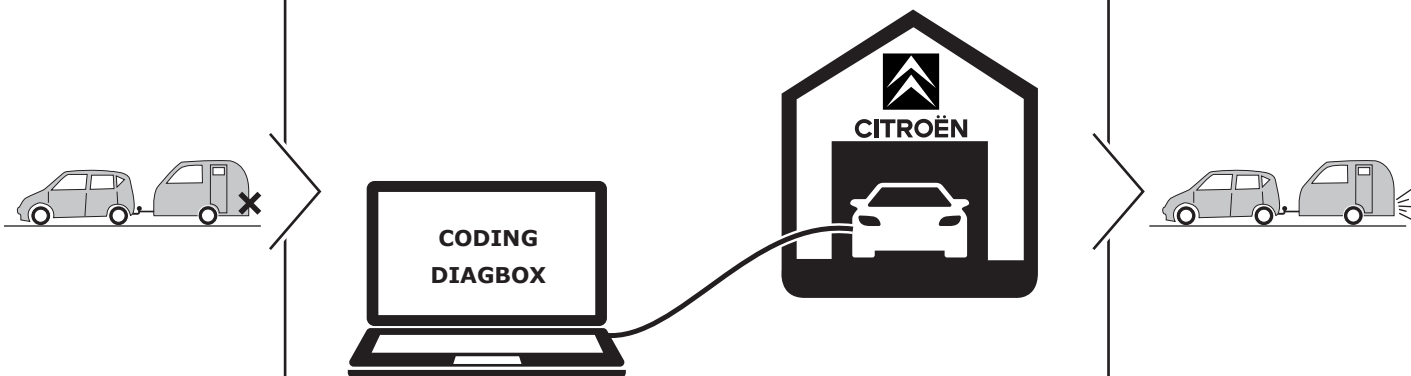

Code vehicle for lighting functions

23



TEST ALL THE CIRCUITS WITH A TEST DEVICE WITH THE CORRECT POWER LOAD FOR EACH FUNCTION. A TEST DEVICE WITH LED'S CANNOT BE USED FOR THIS PURPOSE.

INFO

REINSTALL TRIM.

24

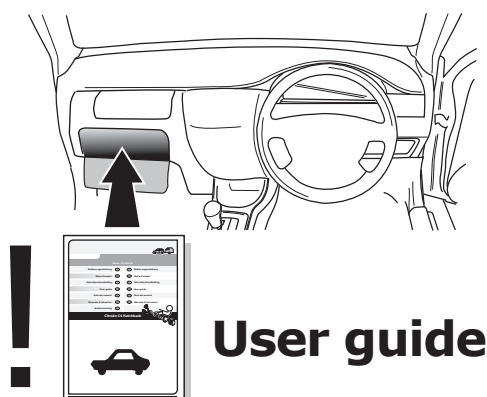







User guide

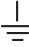

**00800
22 55 23 27
CALL2ECS**

Monday - Friday
08.00am - 11.00am
12.00am - 05.00pm GMT
customer@ecs-electronics.com
www.ecs-electronicsuk.co.uk

SOCKET CONNECTION

DIN/ISO 1724			 1-7				
	1/L	2	3/31	4/R	5/58-R	6/54	7/58-L
Pmax	21W	21W		21W	42W	3x21W	42W
Colour	Yellow	Blue	White	Green	Brown	Red	Black

⚠ MAX = 21W

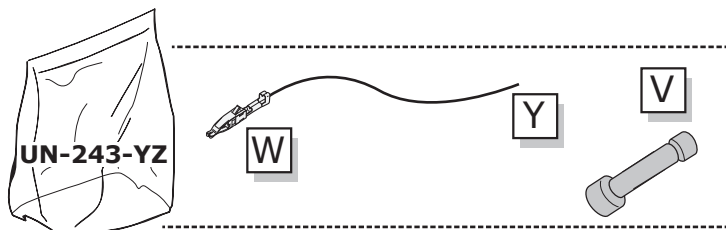

A

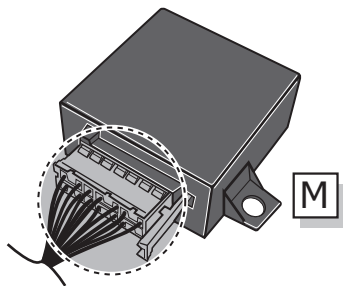

1

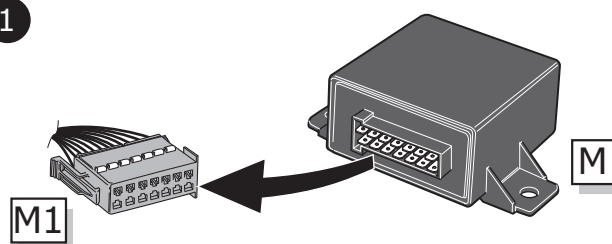

2

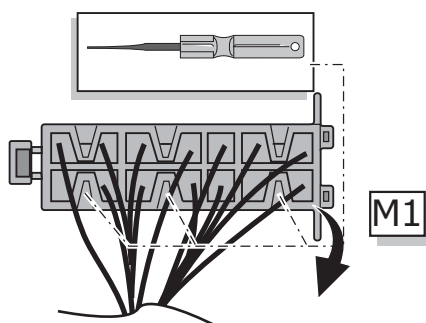

3

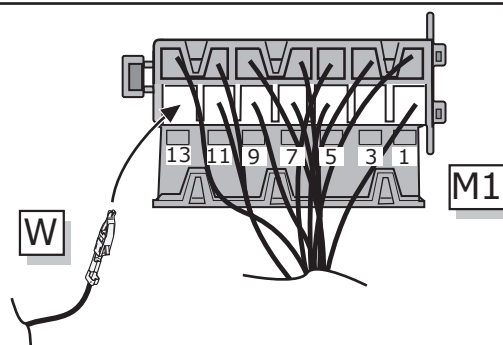

4

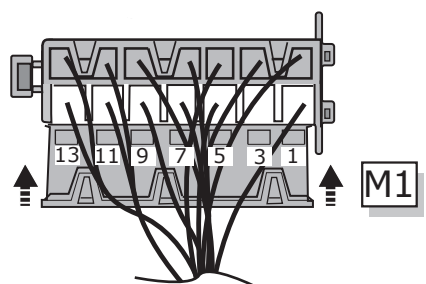

5

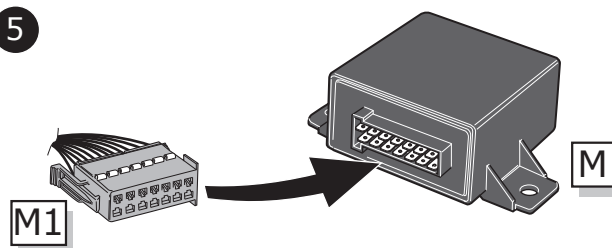

B

⚠ MAX = 21W

