

**Nissan X-trail 10/2007-
Nissan Qashqai 2007-
Nissan Qashqai+2 2008-**

Partnr.: NI-041-DHU

- Fitting instructions electric wiring kit tow bar with 13-P socket up to DIN/ISO Norm 11446.
- We would expressly point out that assembly not carried out properly by a competent installer will result in cancellation of any right to damage compensation, in particular those arising by virtue of the product liability act.
- Contents of these kits and their fitting manuals are subject to alteration without notice, please ensure that these instructions are read and fully understood before commencing installation.
- Do not overload circuits; the maximum loads per connection are detailed in this manual.
- Attention! Before Installation, please read this manual carefully and inform your customer to consult the vehicle owners manual to check for any vehicle modifications required before towing.
- In the event of functional problems, troubleshooting must be limited to about 0.5 hours, contact the installers support: customercare@ecs-electronics.com / 00800 22 55 23 27.



**00800
22 55 23 27
CALL2ECS**

Monday - Friday
08.00am - 11.00am
12.00am - 05.00pm GMT

customercare@ecs-electronics.com
www.ecs-electronicsuk.co.uk

Part list

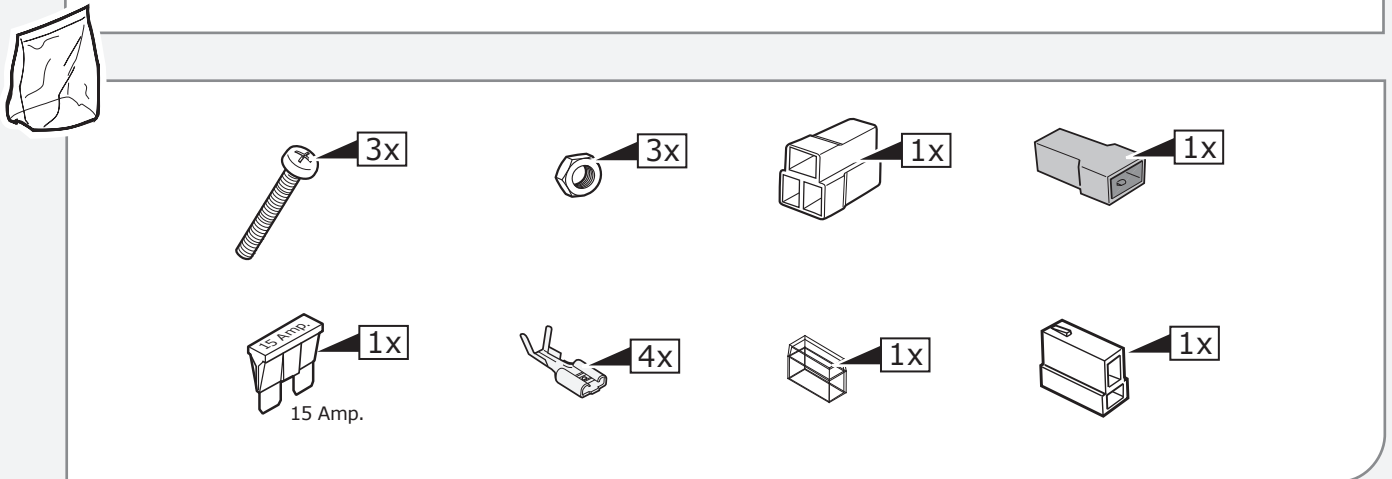
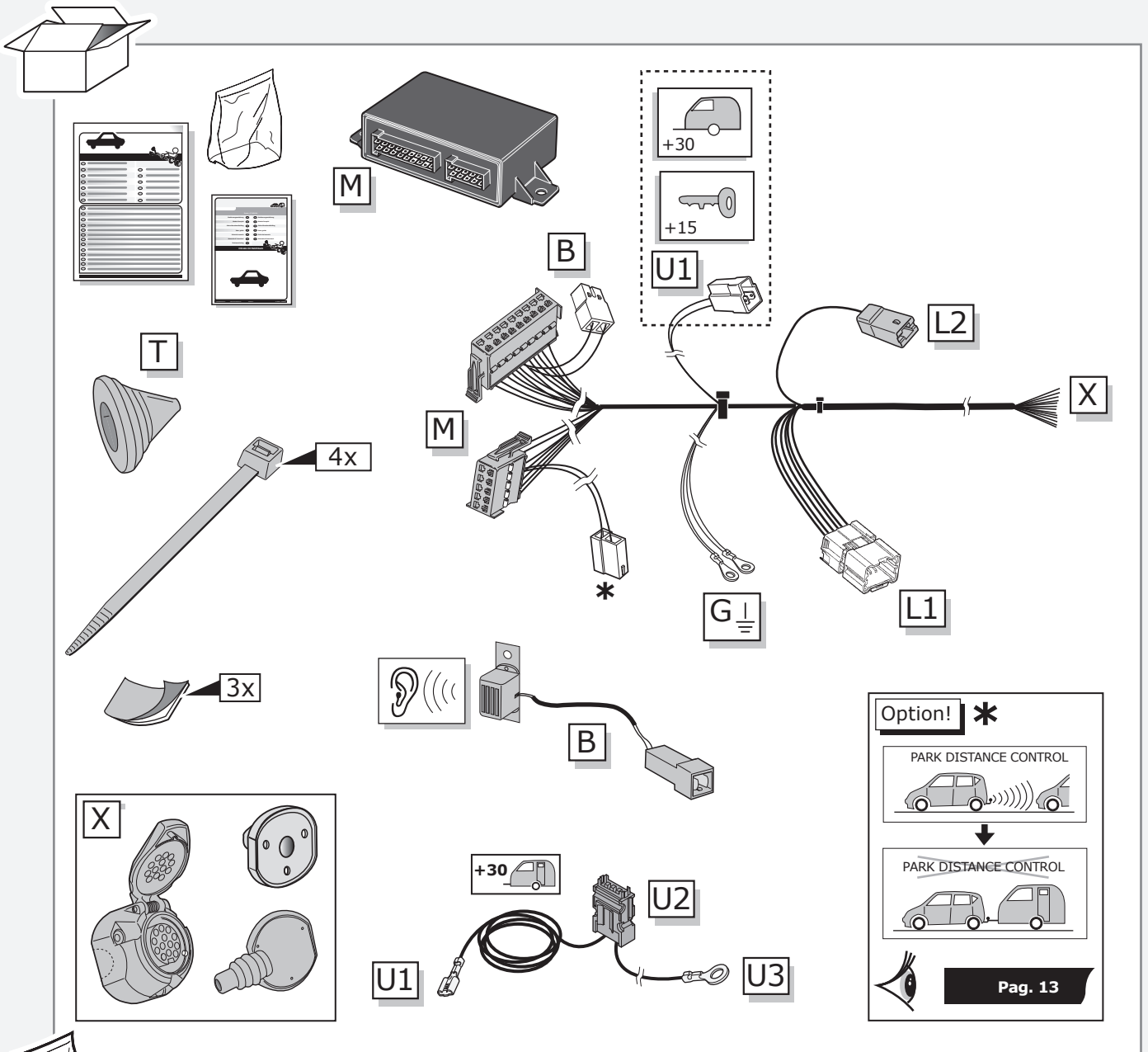

ROUTING

X-trail

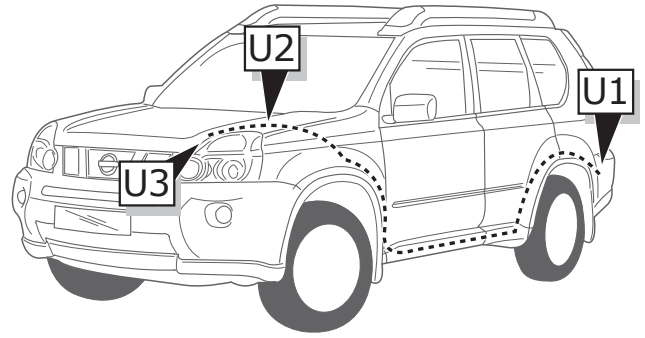
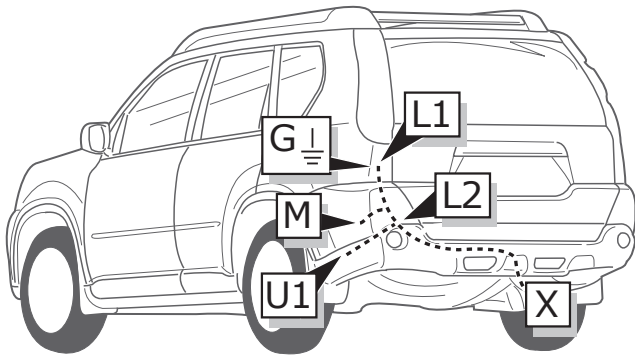

Qashqai & Qashqai+2

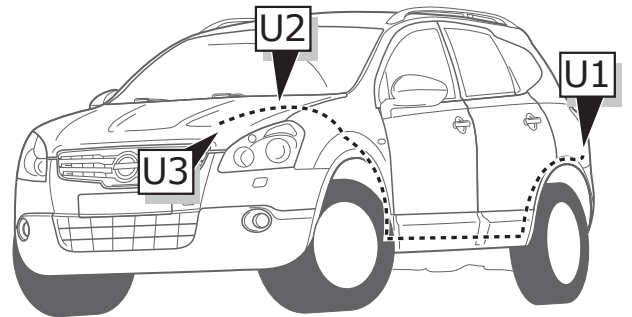
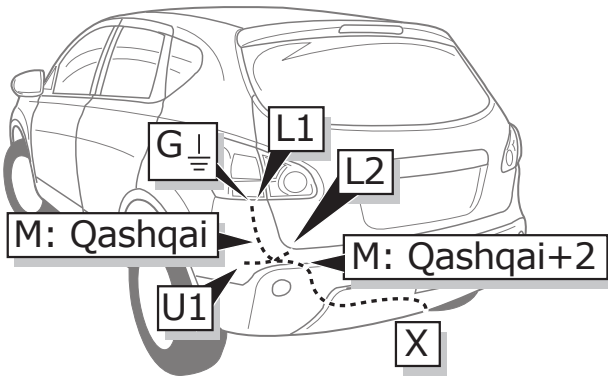

1

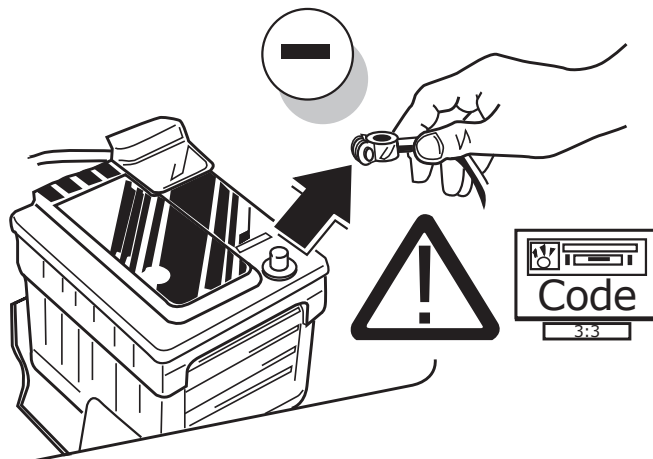

2

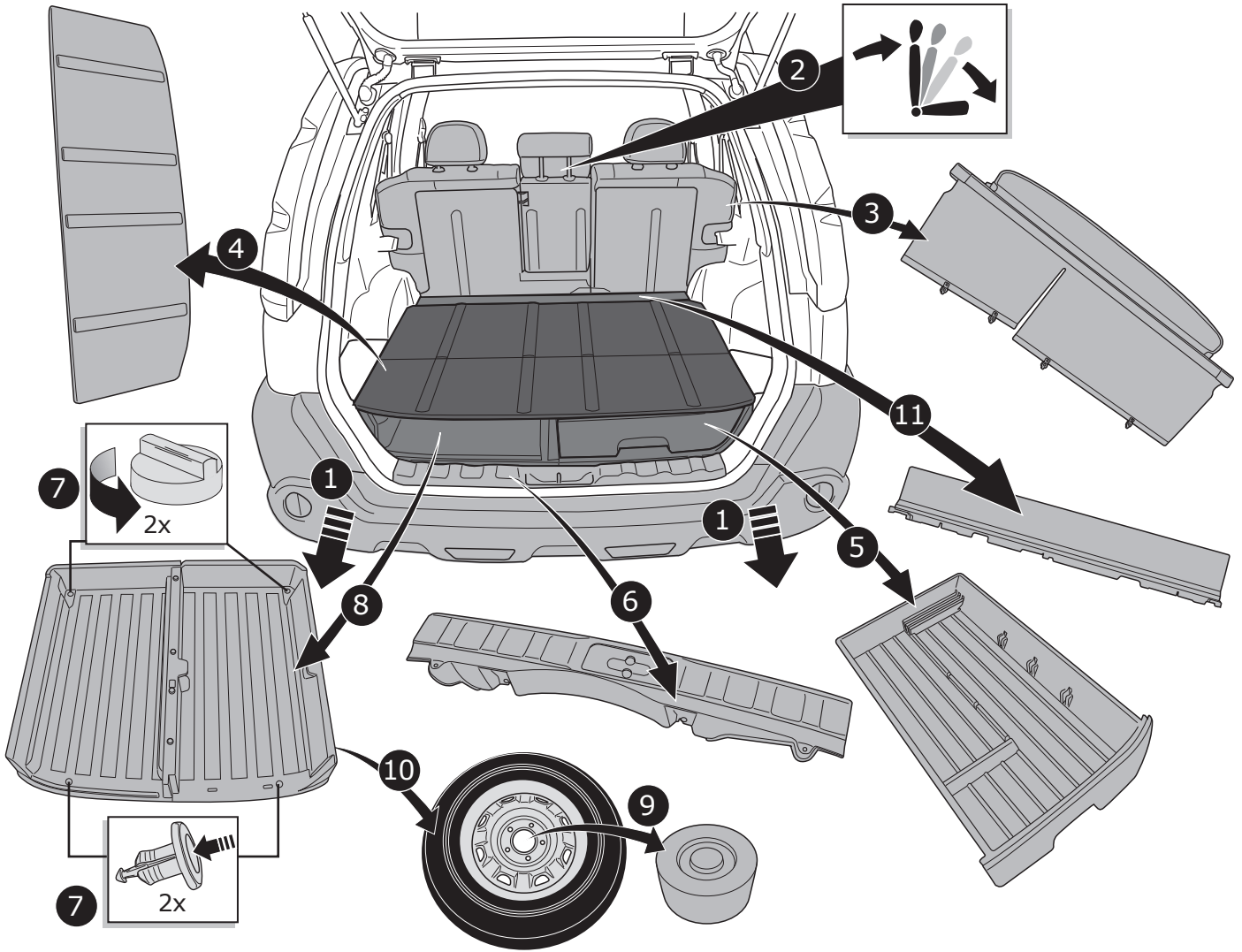

3

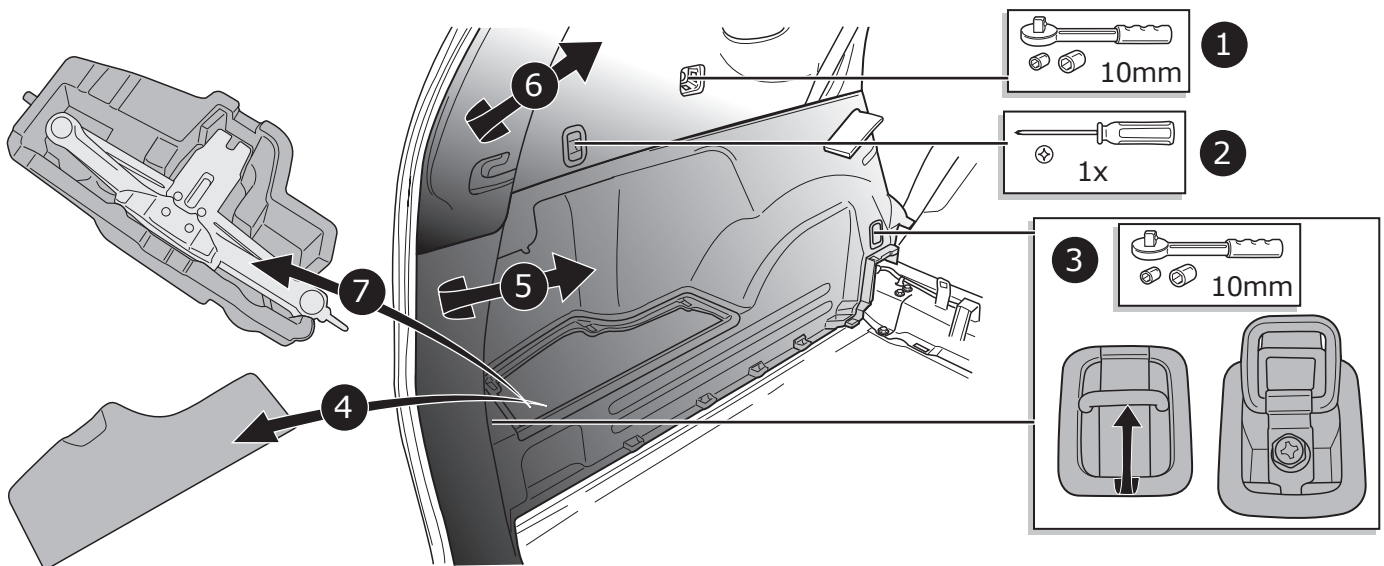

Qashqai

4

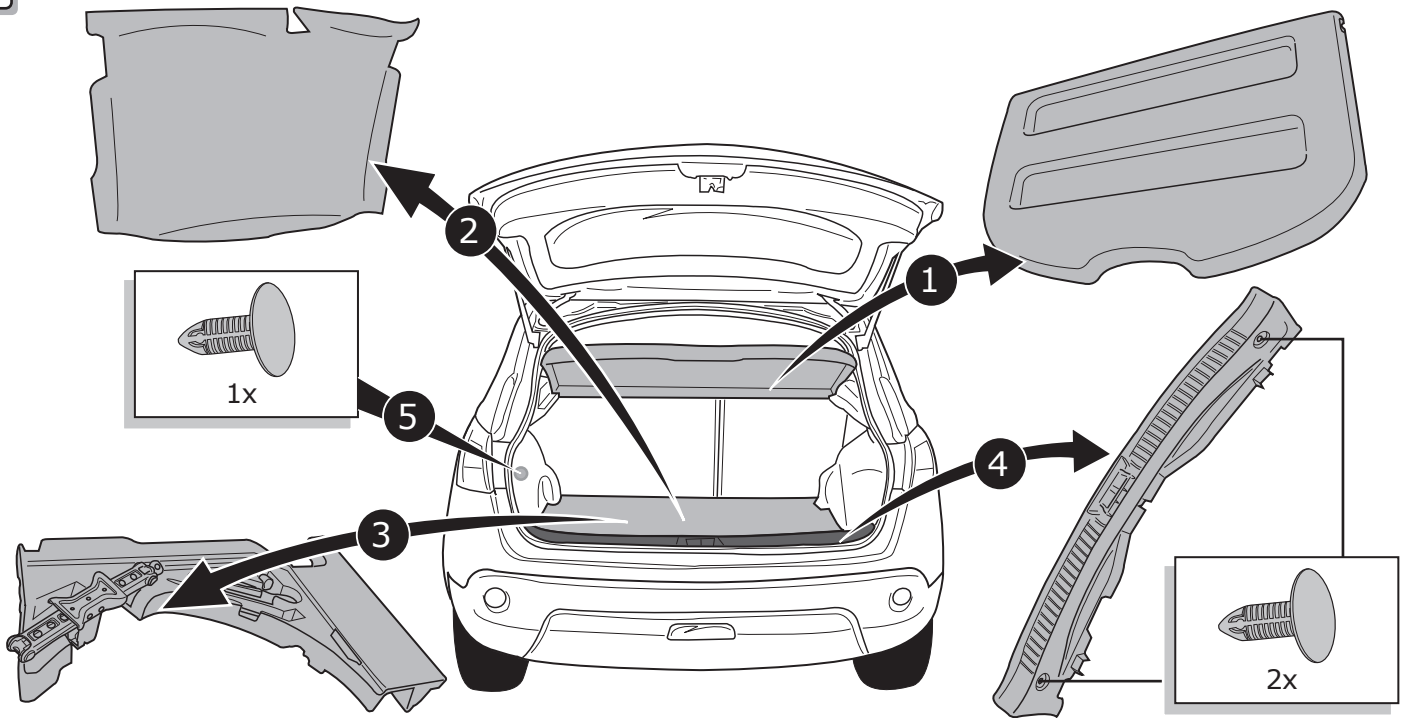

Qashqai+2

5

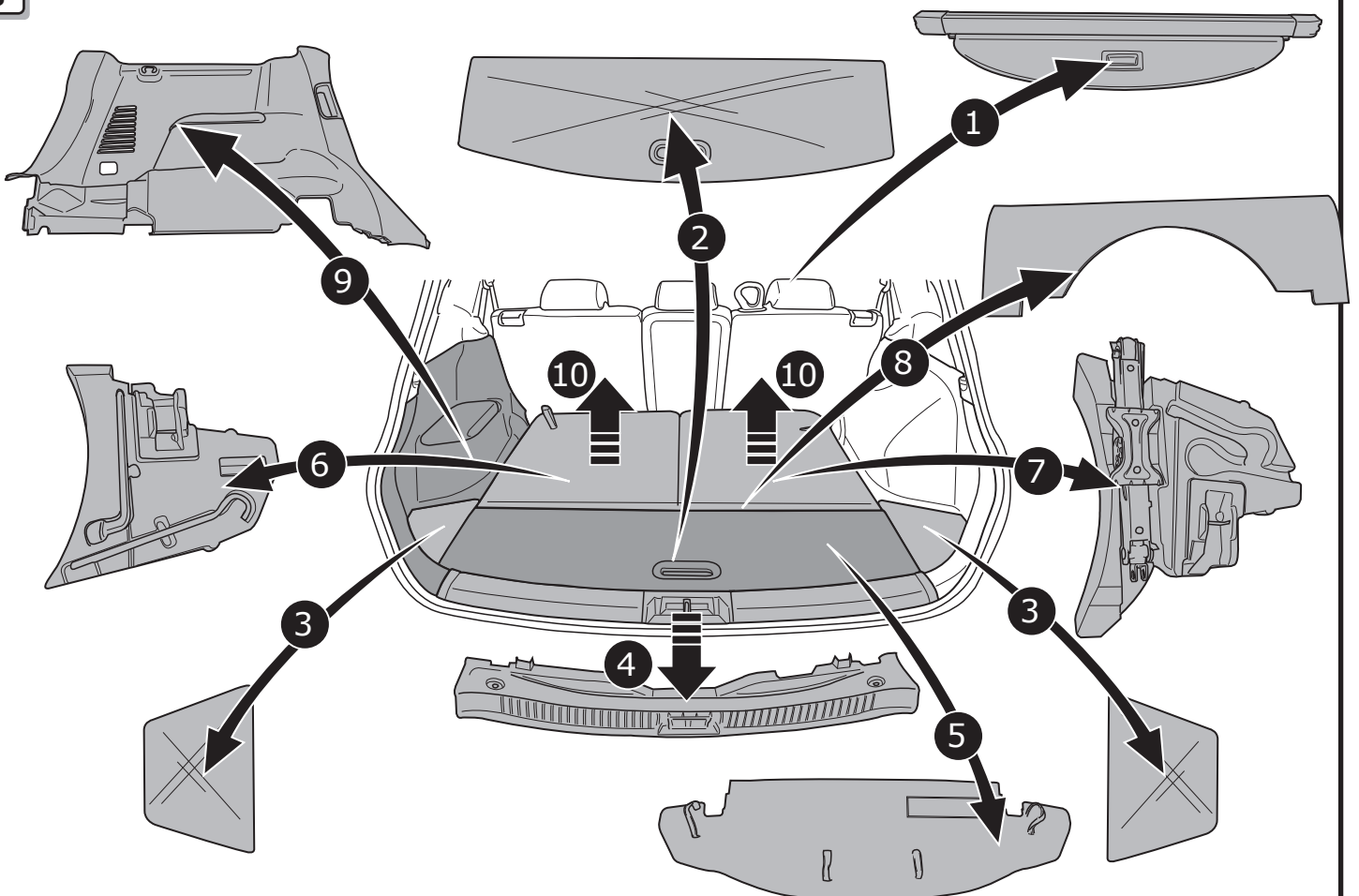

X-trail

6

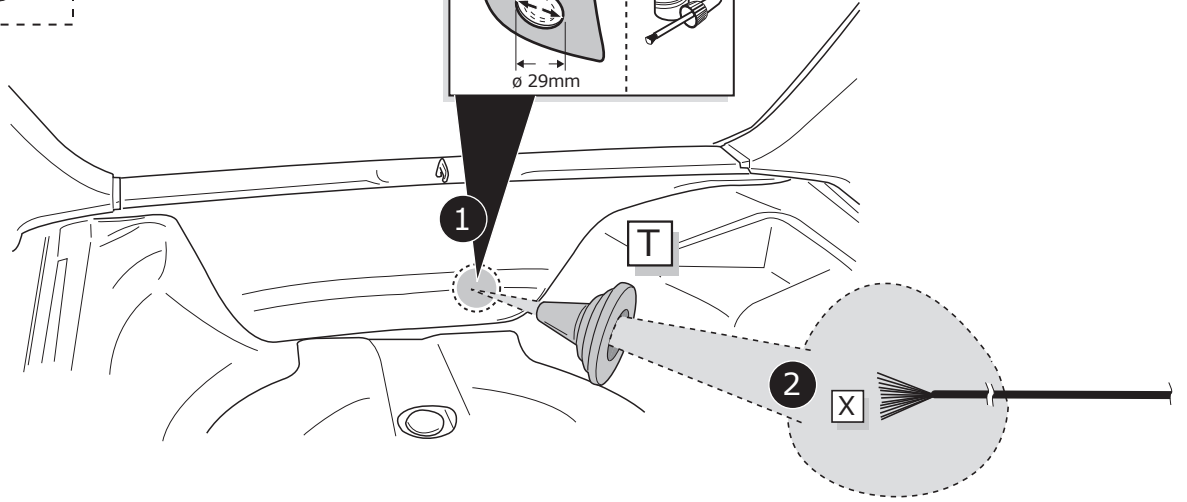
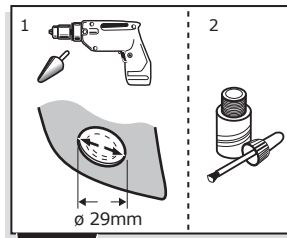
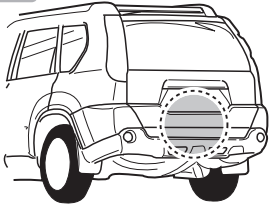

Qashqai & Qashqai+2

7

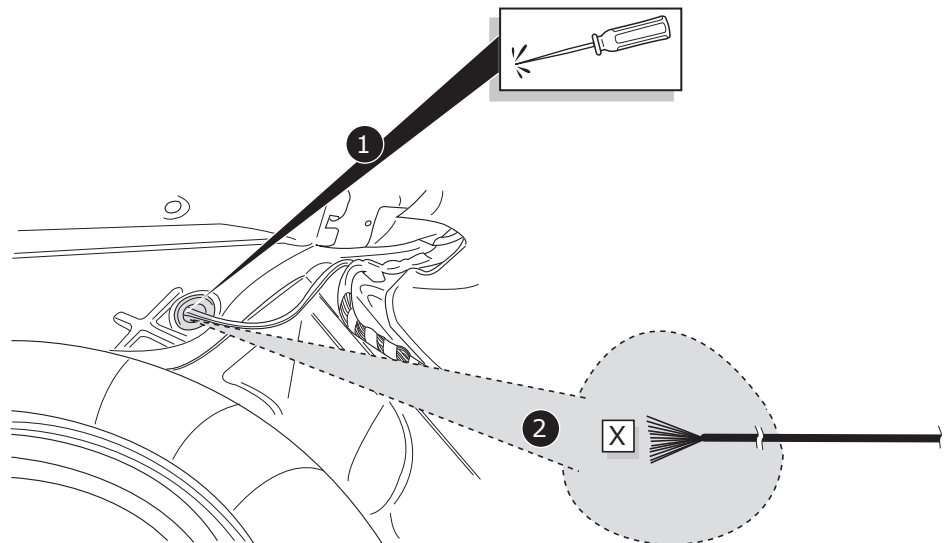
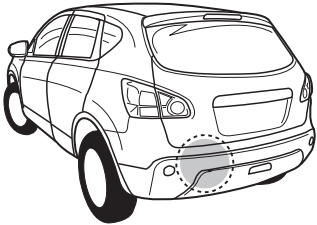

A Option 1

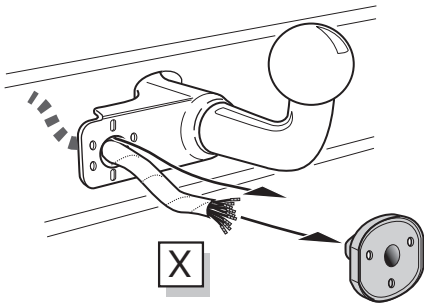

Option 2

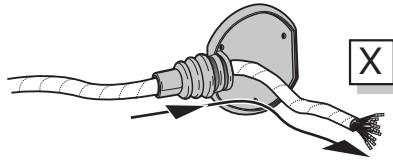

Option 3

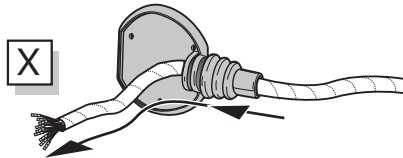

INFO

SOCKET CONNECTION



Pag. 12

B Option 1

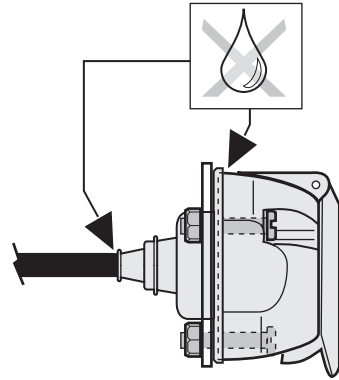
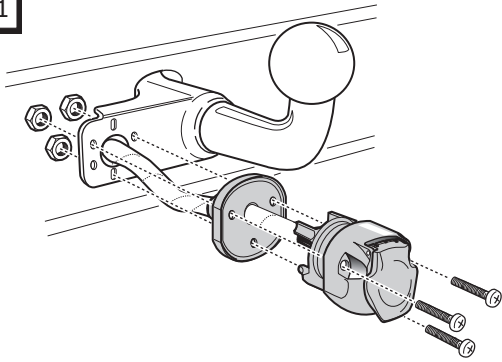

C Option 2

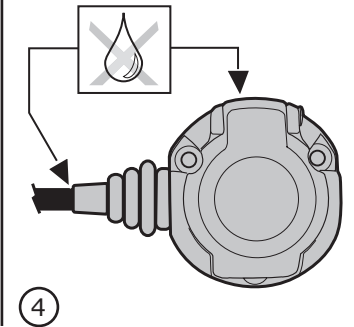
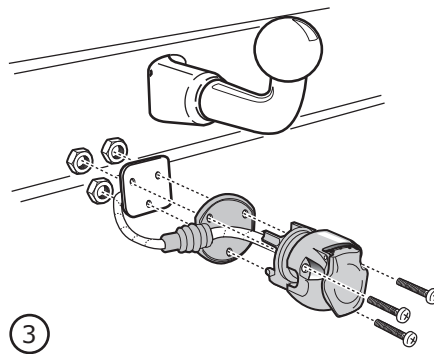
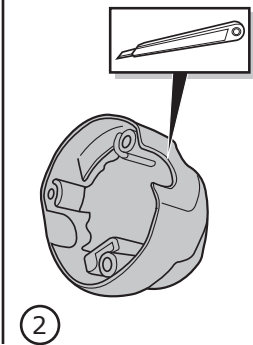
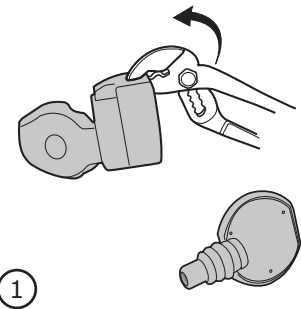

D Option 3

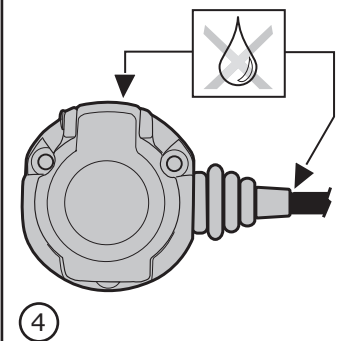
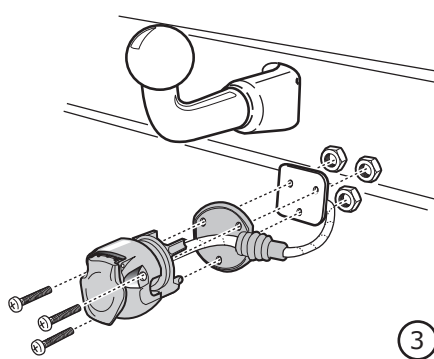
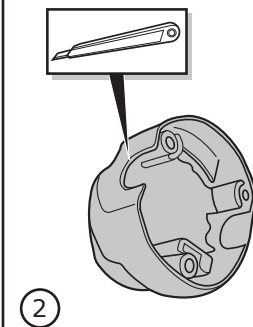
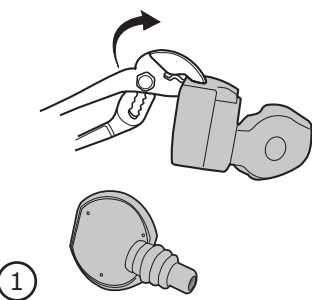

X-trail

8

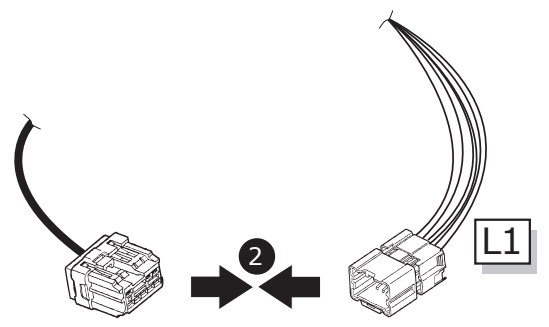
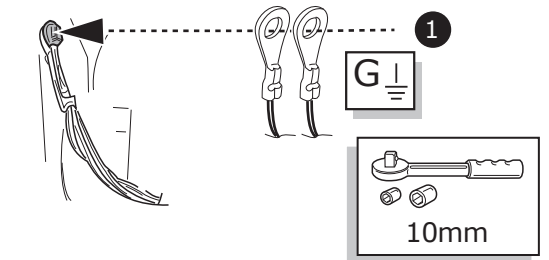
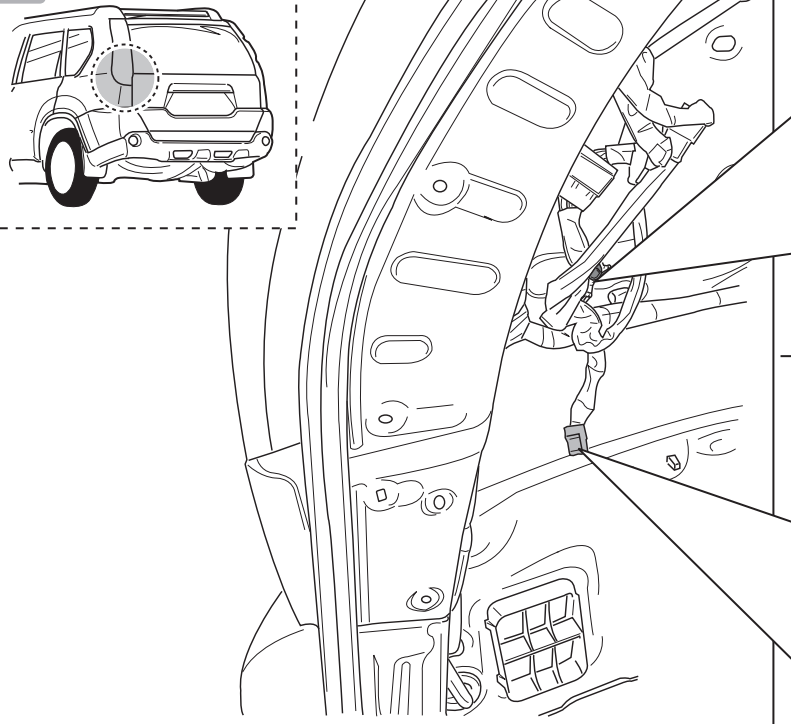

Qashqai & Qashqai+2

9

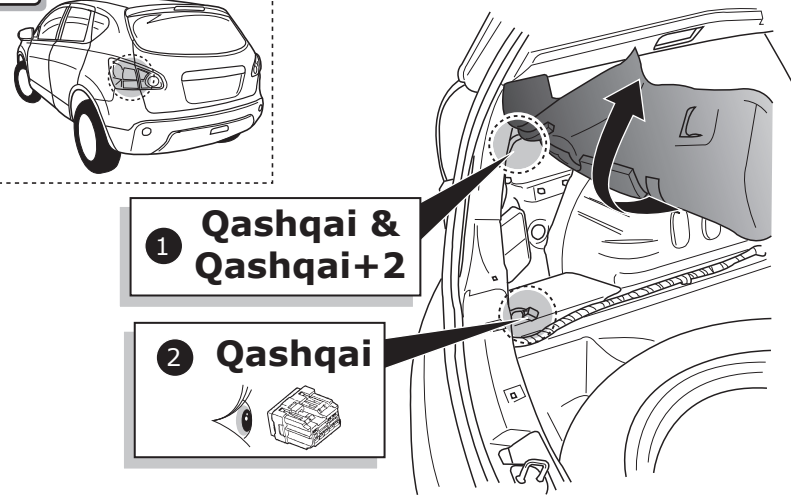

1 Qashqai & Qashqai+2

2 Qashqai

Qashqai & Qashqai+2

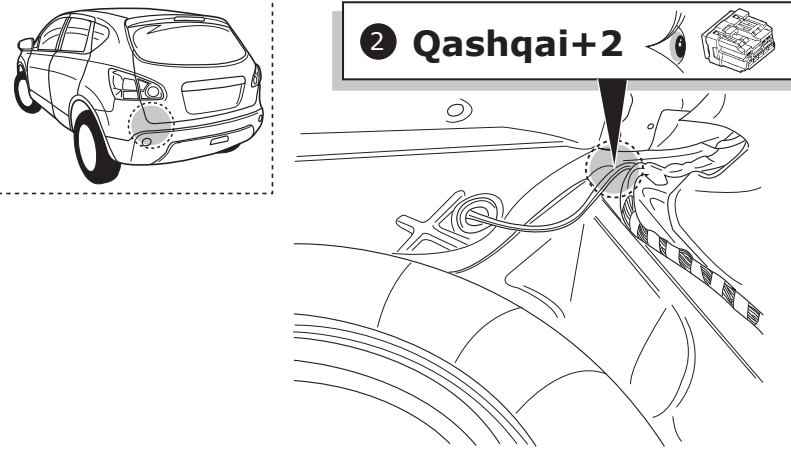
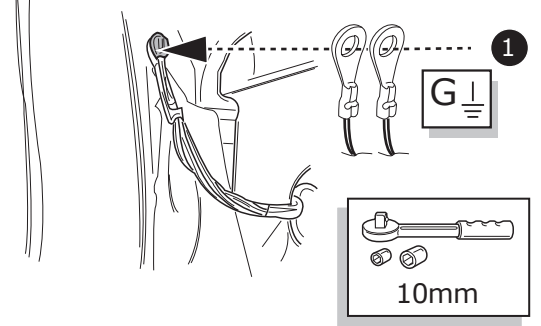

2 Qashqai+2

Qashqai & Qashqai+2

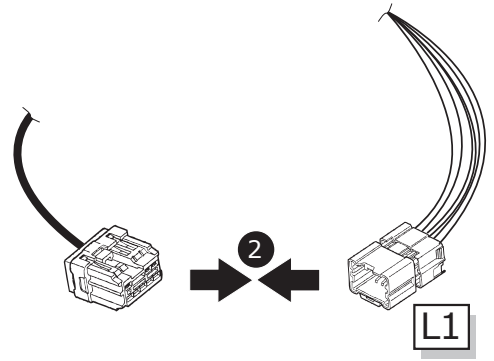

10

X-trail

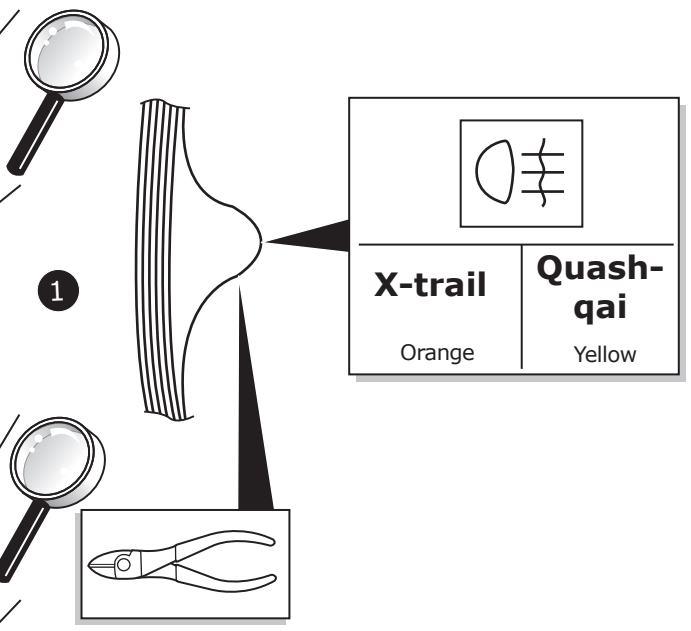
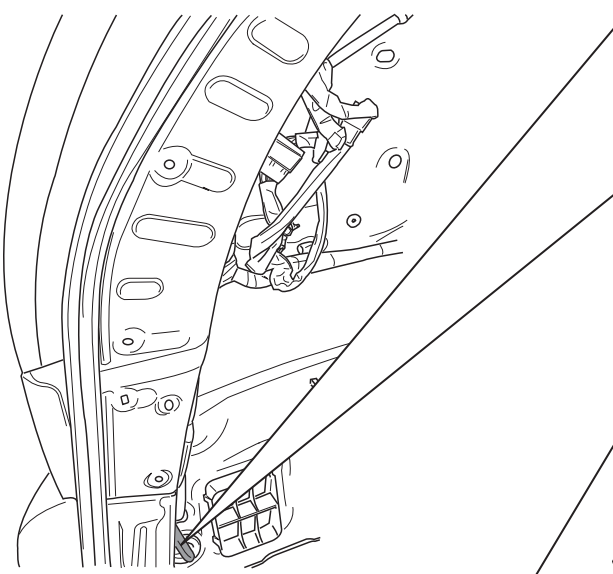

2

Qashqai & Qashqai+2

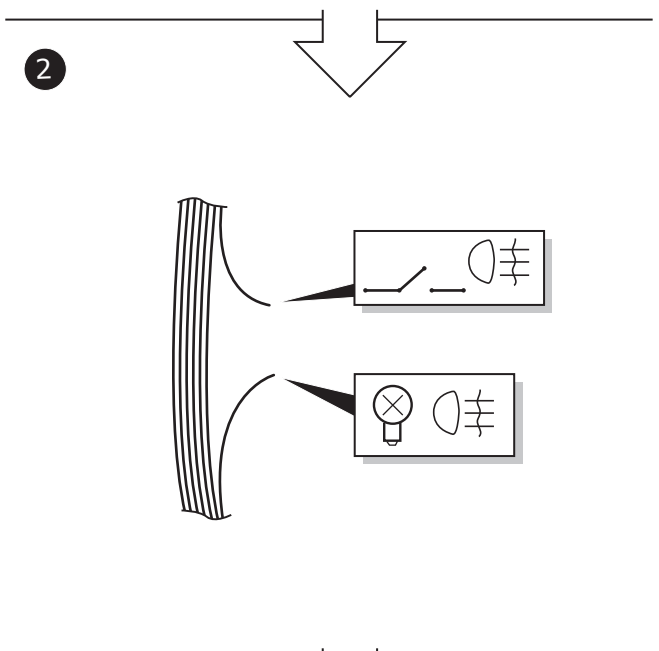
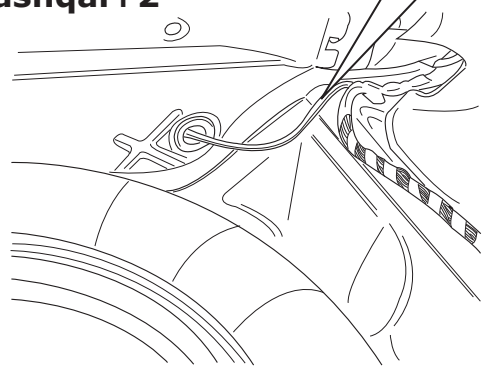

3

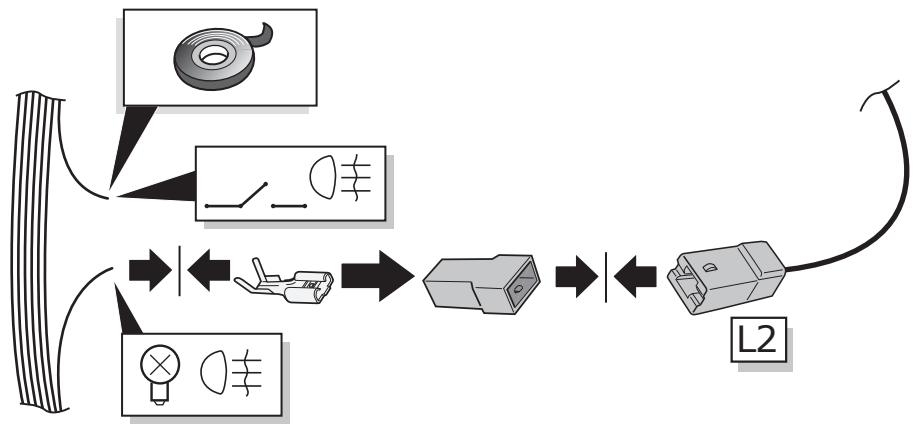

X-trail & Qashqai & Qashqai+2

11

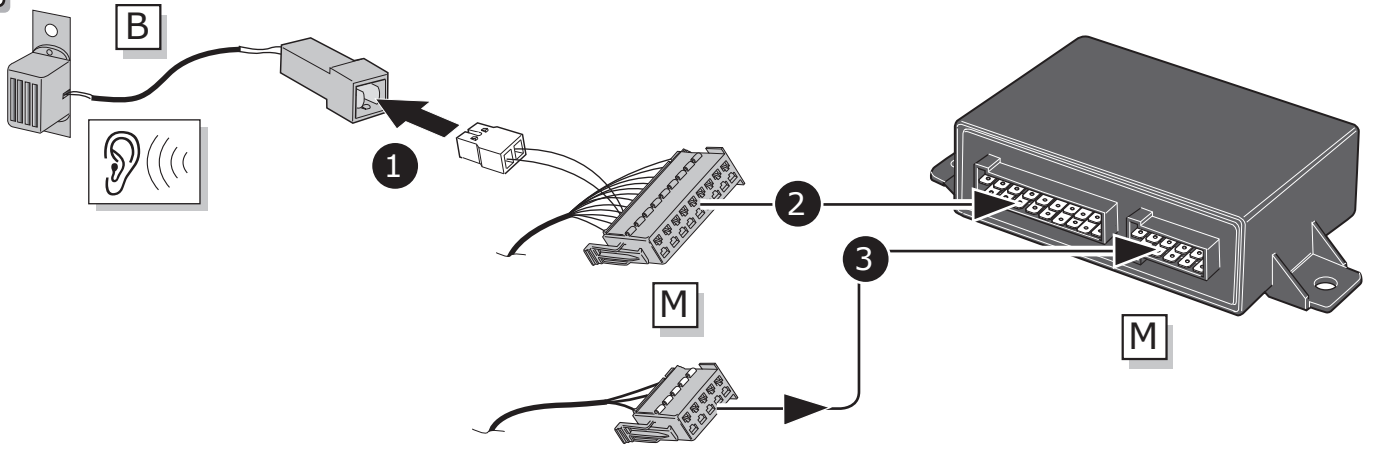

12

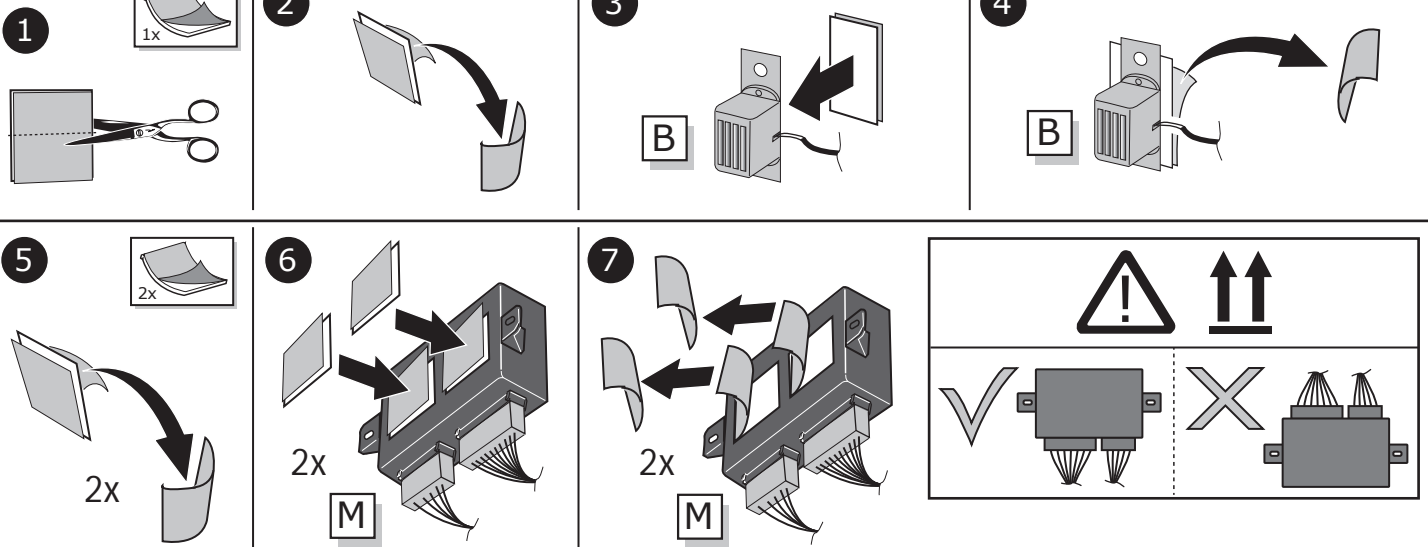

X-trail

13

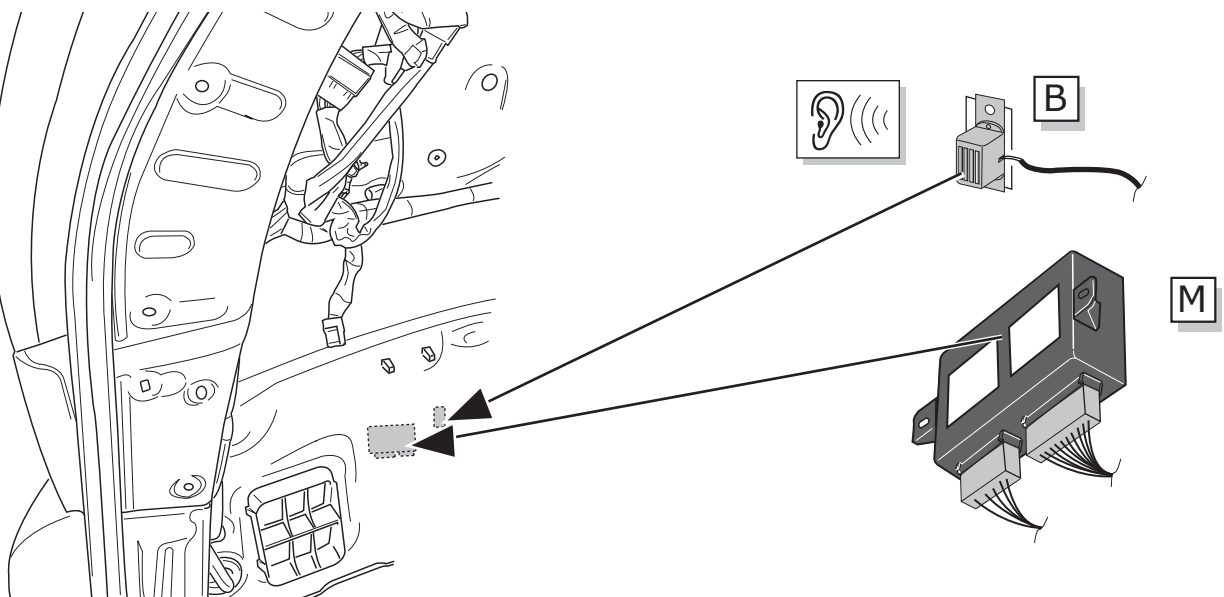

Qashqai & Qashqai+2

14

Qashqai

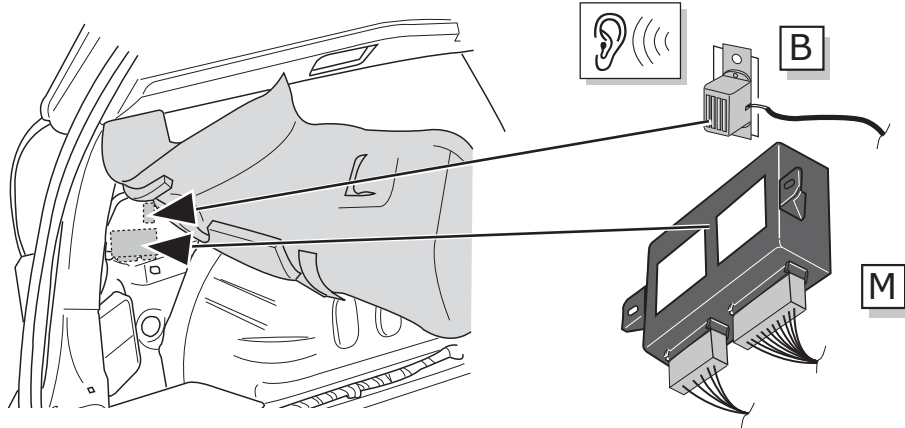

Qashqai+2

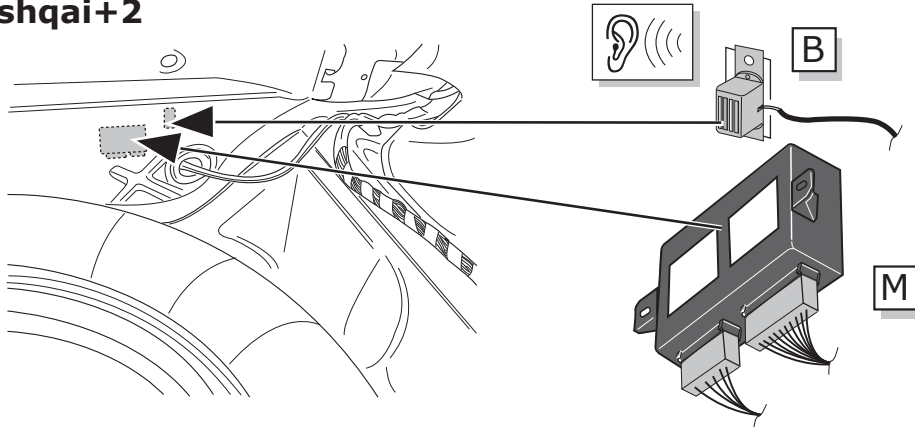

X-trail & Qashqai & Qashqai+2

15

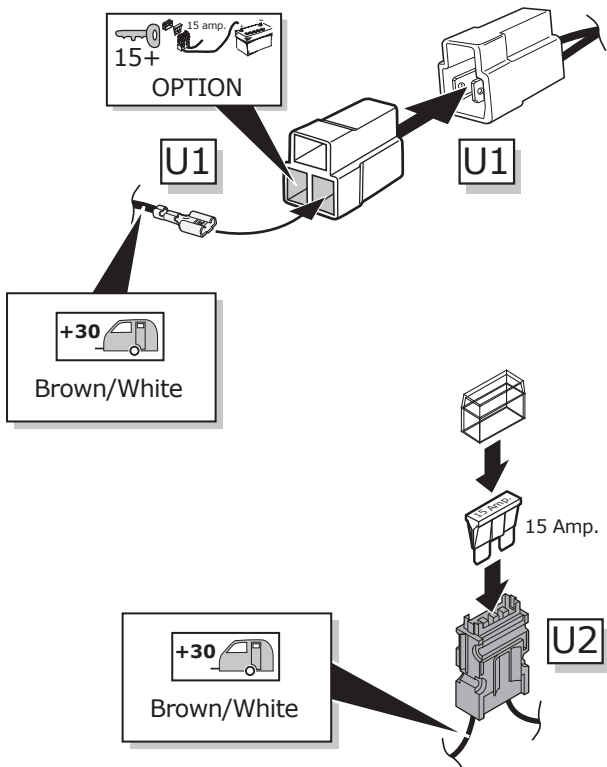

16

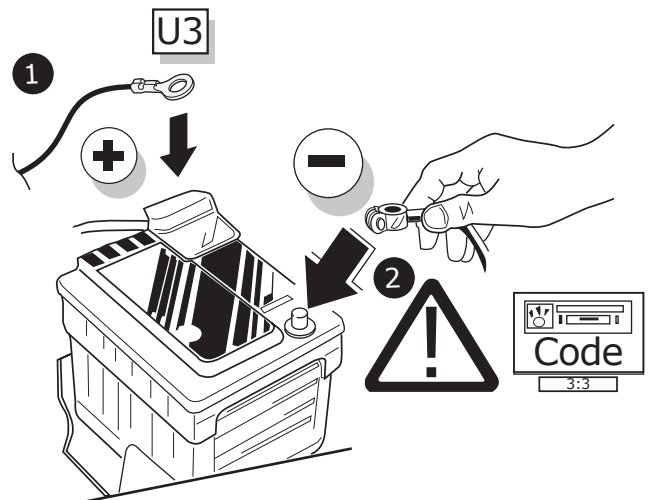

17

! TEST ALL THE CIRCUITS WITH A TEST DEVICE WITH THE CORRECT POWER LOAD FOR EACH FUNCTION. A TEST DEVICE WITH LED'S CANNOT BE USED FOR THIS PURPOSE.

INFO

REINSTALL TRIM.

18

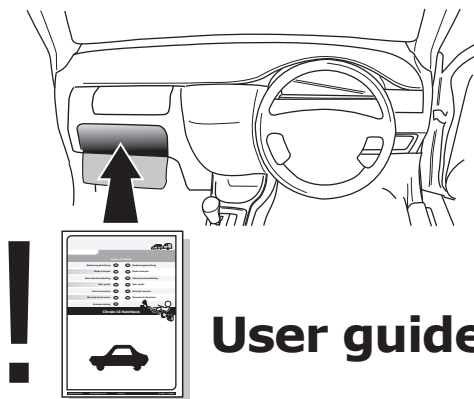

User guide



**00800
22 55 23 27
CALL2ECS**

Monday - Friday
08.00am - 11.00am
12.00am - 05.00pm GMT
customercare@ecs-electronics.com
www.ecs-electronicsuk.co.uk

INFO

SOCKET CONNECTION

DIN/ISO 11446													
	1/L	2	3/31	4/R	5/58-R	6/54	7/58-L	8	9	10	11	12	13
Pmax	21W	2x21W		21W	52W	3x21W	52W	2x21W	180W/15Amp	180W/15Amp			
Colour	Yellow	Blue	White	Green	Brown	Red 1,00 mm ²	Black	Black/ Red	Brown/ White	Red 2,50 mm ²	White	-	White

