

**Iveco Daily 01/2011 - 04/2014**

**Partnr.: IV-004-BDU**

- Fitting instructions electric wiring kit tow bar with 12-N socket up to DIN/ISO Norm 1724.
- We would expressly point out that assembly not carried out properly by a competent installer will result in cancellation of any right to damage compensation, in particular those arising by virtue of the product liability act.
- Contents of these kits and their fitting manuals are subject to alteration without notice, please ensure that these instructions are read and fully understood before commencing installation.
- Do not overload circuits; the maximum loads per connection are detailed in this manual.
- Attention! Before Installation, please read this manual carefully and inform your customer to consult the vehicle owners manual to check for any vehicle modifications required before towing.
- In the event of functional problems, troubleshooting must be limited to about 0.5 hours, contact the installers support: [customercare@ecs-electronics.com](mailto:customercare@ecs-electronics.com) / 00800 22 55 23 27.



**00800  
22 55 23 27  
CALL2ECS**

Monday - Friday

08.00am - 11.00am

12.00am - 05.00pm GMT

[customercare@ecs-electronics.com](mailto:customercare@ecs-electronics.com)

[www.ecs-electronicsuk.co.uk](http://www.ecs-electronicsuk.co.uk)

# Part list

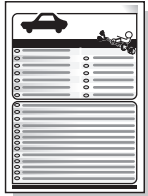
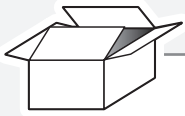

L1



X

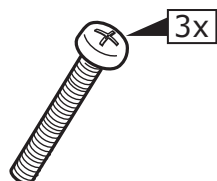
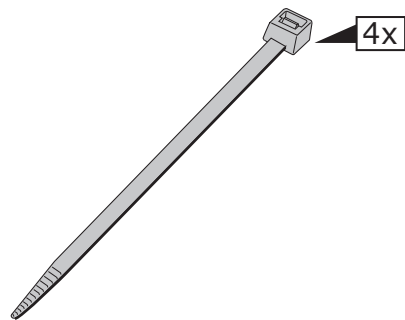
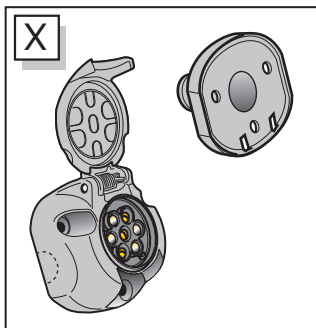

1

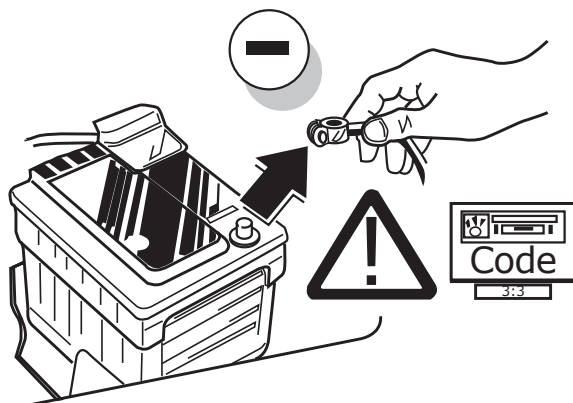

2

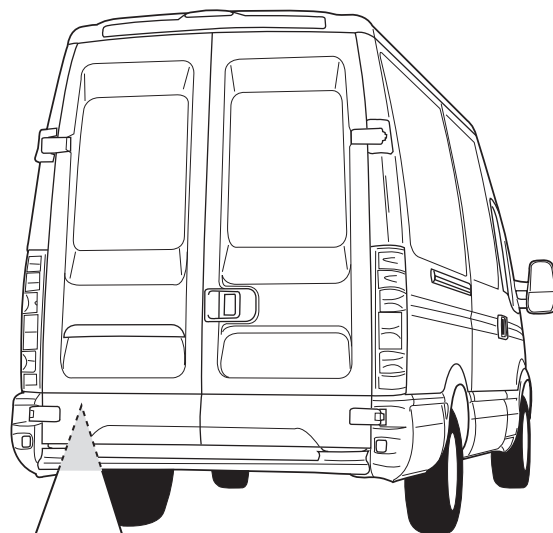
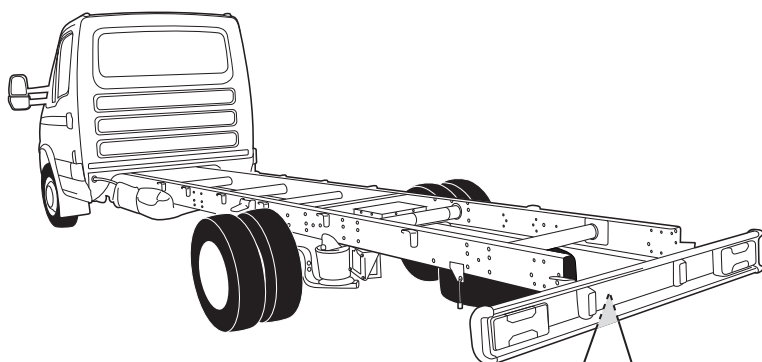

1

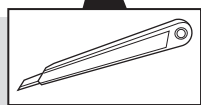
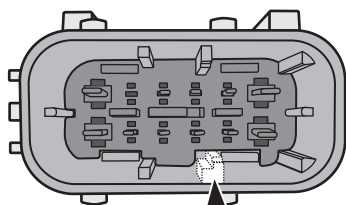

2

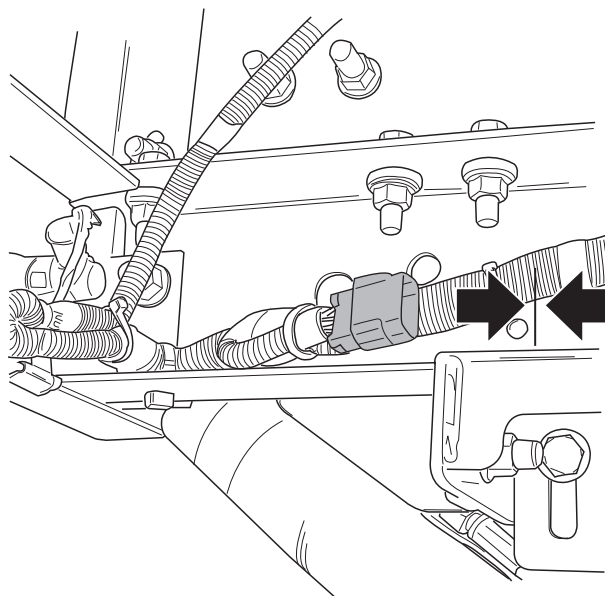

L1

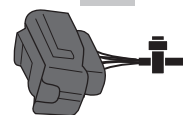

A

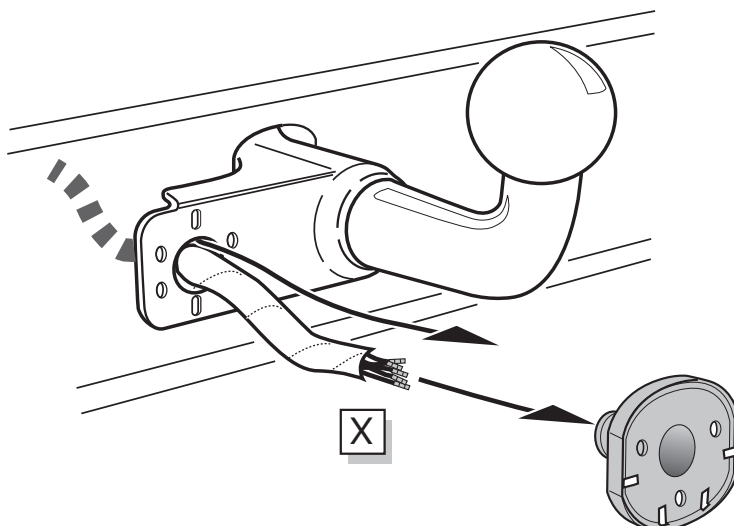

# INFO

SOCKET CONNECTION



Pag. 6

B

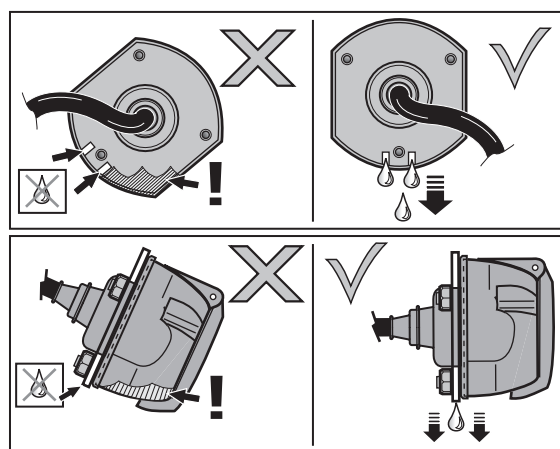
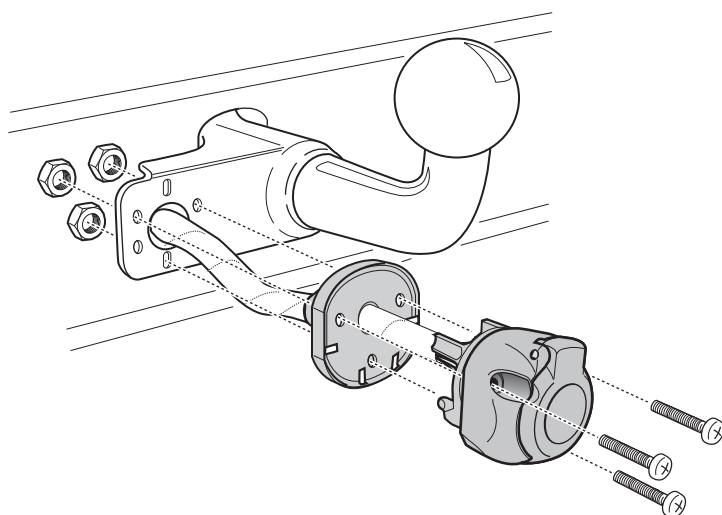

3

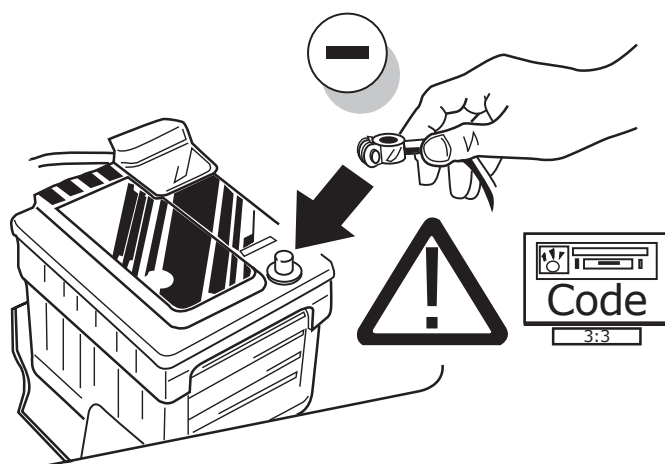

4

TEST ALL THE CIRCUITS WITH A TEST DEVICE WITH THE CORRECT POWER LOAD FOR EACH FUNCTION. A TEST DEVICE WITH LED'S CANNOT BE USED FOR THIS PURPOSE.

5

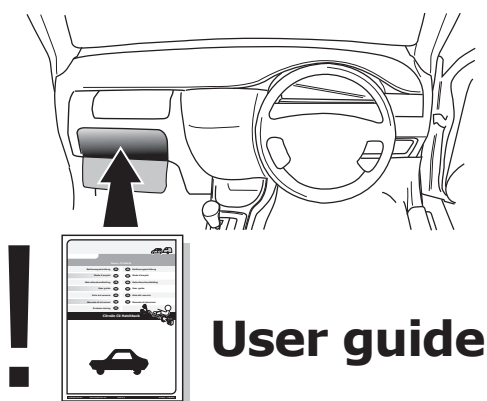

**00800  
22 55 23 27  
CALL2ECS**







Monday - Friday

08.00am - 11.00am

12.00am - 05.00pm GMT

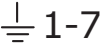
customer@ecs-electronics.com  
www.ecs-electronicsuk.co.uk

SOCKET CONNECTION

DIN/ISO 1724							
	1/L	2	3/31	4/R	5/58-R	6/54	7/58-L
Pmax	21W	2x21W		21W	52W	3x21W	52W
Colour	Yellow	Blue	White	Green	Brown	Red	Black