

Parts List:

Part No:	Description:	Size:	Torque	Qty:
1	Crossbar			1
2	R/H Side Arm			1
3	L/H Side Arm			1
4	Bolt + Spring Washer + Flat Washer	M12 x 45	105Nm	6
5	Bolt + Spring Washer + Flat Washer (x2) + Nut	M12 x 55	105Nm	4
6	Bolt + Spring Washer + Flat Washer	M12 x 45	105Nm	4
7	Bolt + Spring Washer + Nut	M10 x 35	70Nm	1
8	Socket Plate			1

Fitting:

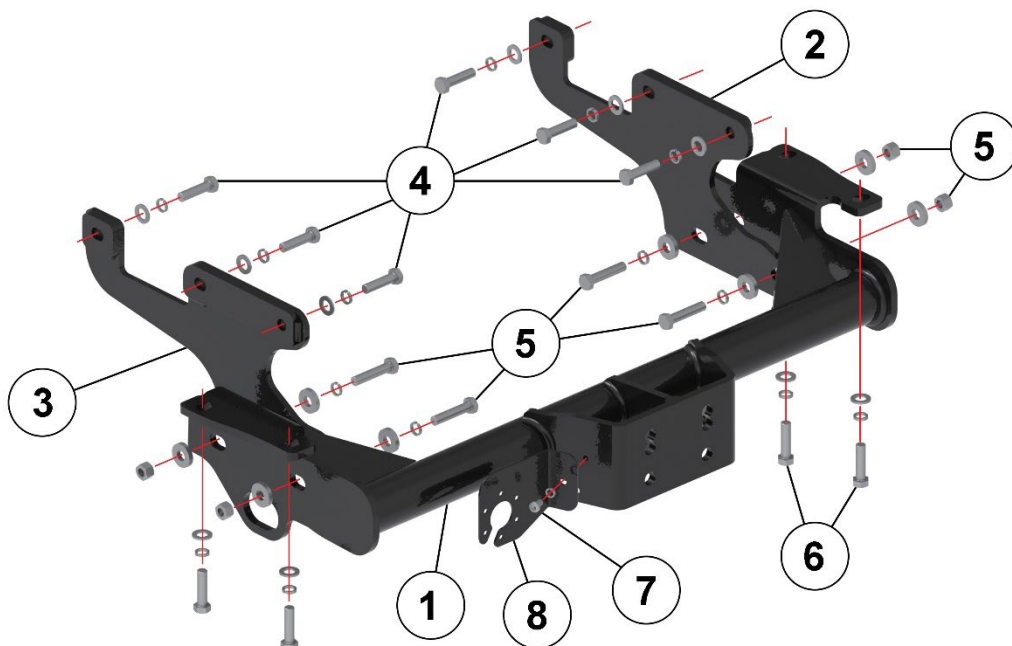

Fitting:

1. Remove the spare wheel (if fitted).

For vehicle without a rear step:

2. A bumper cut is required. (See Drawing on 2nd page).

For vehicles with a rear step:

- 2a. Remove the plastic insert from the centre of the step (Underside of step).
- 2b. Remove brackets from chassis – The towbar replaces these brackets. (Left hand side has towing loop).

All vehicles:

3. Locate vertical mounting points, position crossbar (1) and loosely secure with fixings (6).
4. Loosely attach Sidearms (2) & (3) to Crossbar (1) using fixings (5).
5. Loosely attach Sidearms (2) & (3) to the inside of the chassis rails using fixings (4).
6. Tighten all bolts to recommended torque settings (See above).
7. Attached socket plate (8) using fixings (7).
8. Re-fit spare wheel.

Note: This towbar must be used with a Class A50-1 or A50-X towball, which dimensionally conforms to A50-1 with a 'D' & 'S' value greater than or equal to that of the towbar.

****Manufacturers towing limits must be observed for towing capacity****

Rear View:

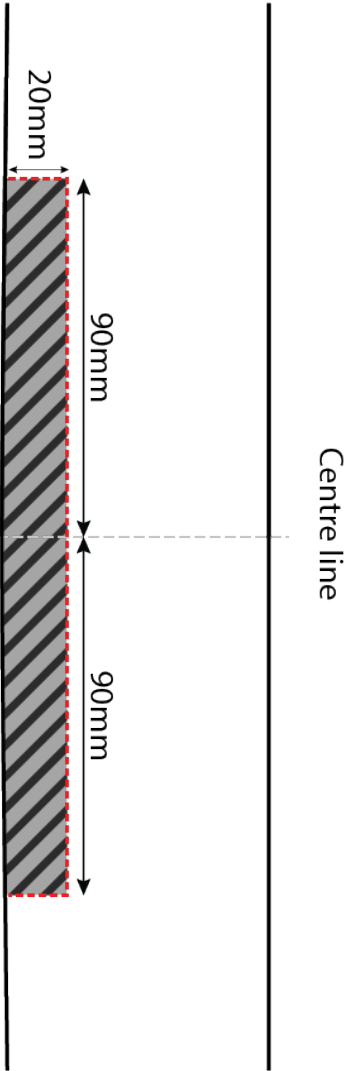

Underside View:

