

Parts List:

Part No:	Description:	Size:	Torque	Qty:
1	Crossbar			1
2	R/H Side Arm			1
3	L/H Side Arm			1
4	Bolt + Spring Washer + Flat Washer + Nut	M12 x 35	105Nm	4
5	Original Bolts	N/A	N/A	8
6	Bolt + Spring Washer + Nyloc Nut	M12 x 100	105Nm	2
7	Bolt + Nyloc Nut	M16 x 60	200 Nm	2
8	Bolt + Spring Washer + Nut	M12 x 25	105NM	1
9	Bolt + Spring Washer + Large Flat Washer	M12 x 35	105Nm	2

Fitting:

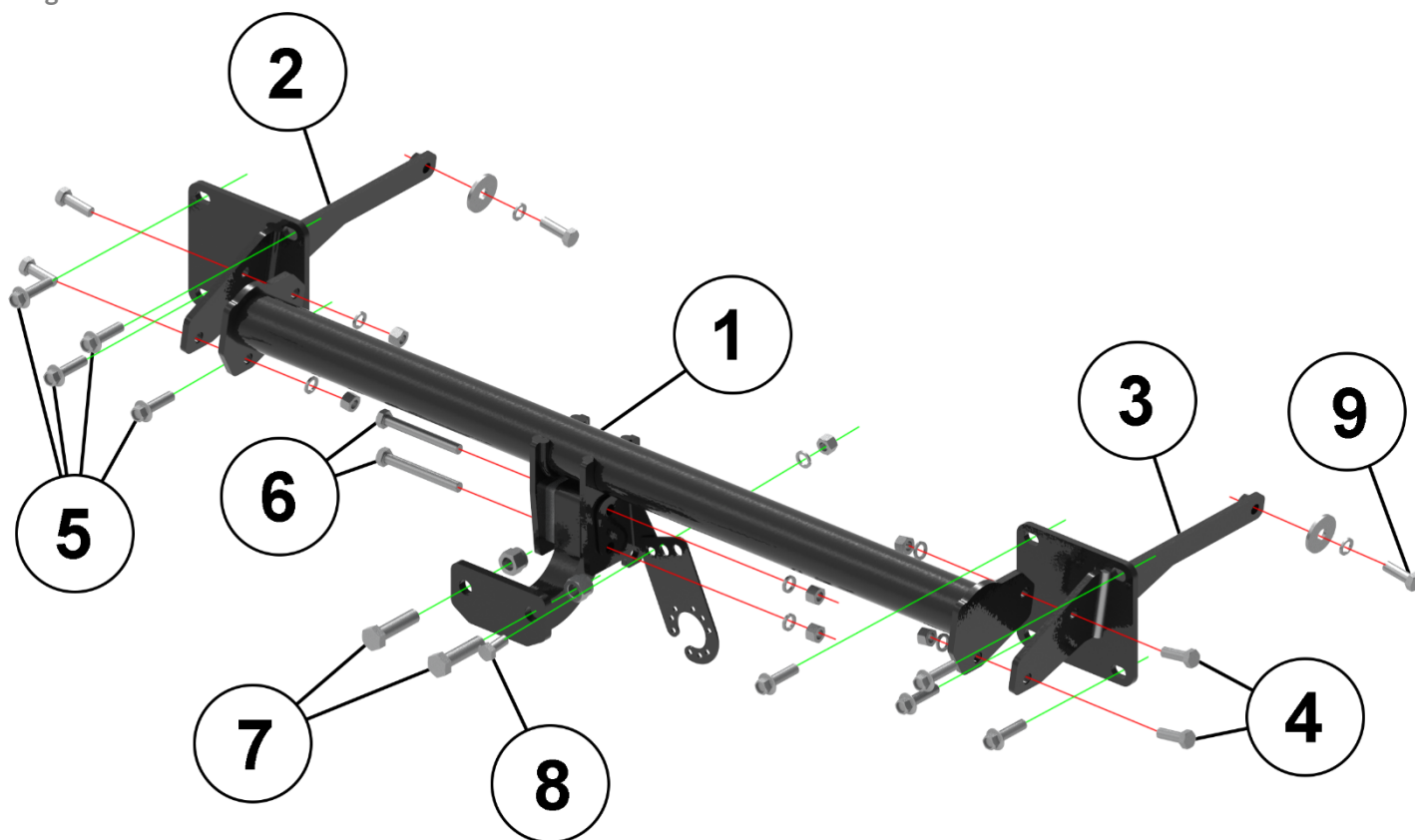

Fitting:

1. Remove the rear bumper (1 fixing located under each light cluster, 4 fixings in each wheel arch, 10 fixings on the underside of the bumper and 8 fixing in the undertray (if fitted)).
2. With all fixings removed and wiring looms disconnected, pull the bumper rearwards to remove.
3. Remove the rear crash beam. Retain the original bolts (5) – these will be used later.
4. Loosely attach sidearms (2) & (3) using original bolts (5) and bolts (9) – Do not fully tighten yet.
5. Loosely attach crossbar (1) to sidearms (2) & (3) using bolts (4) and then fully tighten all bolts.
6. Refit Rear Bumper.
7. Attach neck & electrical plate using bolts (6) and spacers provided.
8. Ensure all bolts are tightened to recommended torque settings and then refit the undertray.

Note: This towbar must be used with a Class A50-1 or A50-X towball, which dimensionally conforms to A50-1 with a 'D' & 'S' value greater than or equal to that of the towbar.

****Manufacturers towing limits must be observed for towing capacity****