

Parts List:

Part No:	Description:	Size:	Torque	Qty:
1	Crossbar			1
2	R/H Side Arm			1
3	L/H Side Arm			1
4	Bolt & Flat Washer	M14 x 140 x 2.0	130Nm	8
5	Bolt + Flat Washer & Nyloc Nut	M12 x 25 x 1.75	80Nm	6
6	Coupling Packer			1
7	Bolt + Shakeproof Washer & Nut	M16 x 60	200Nm	2

Fitting:

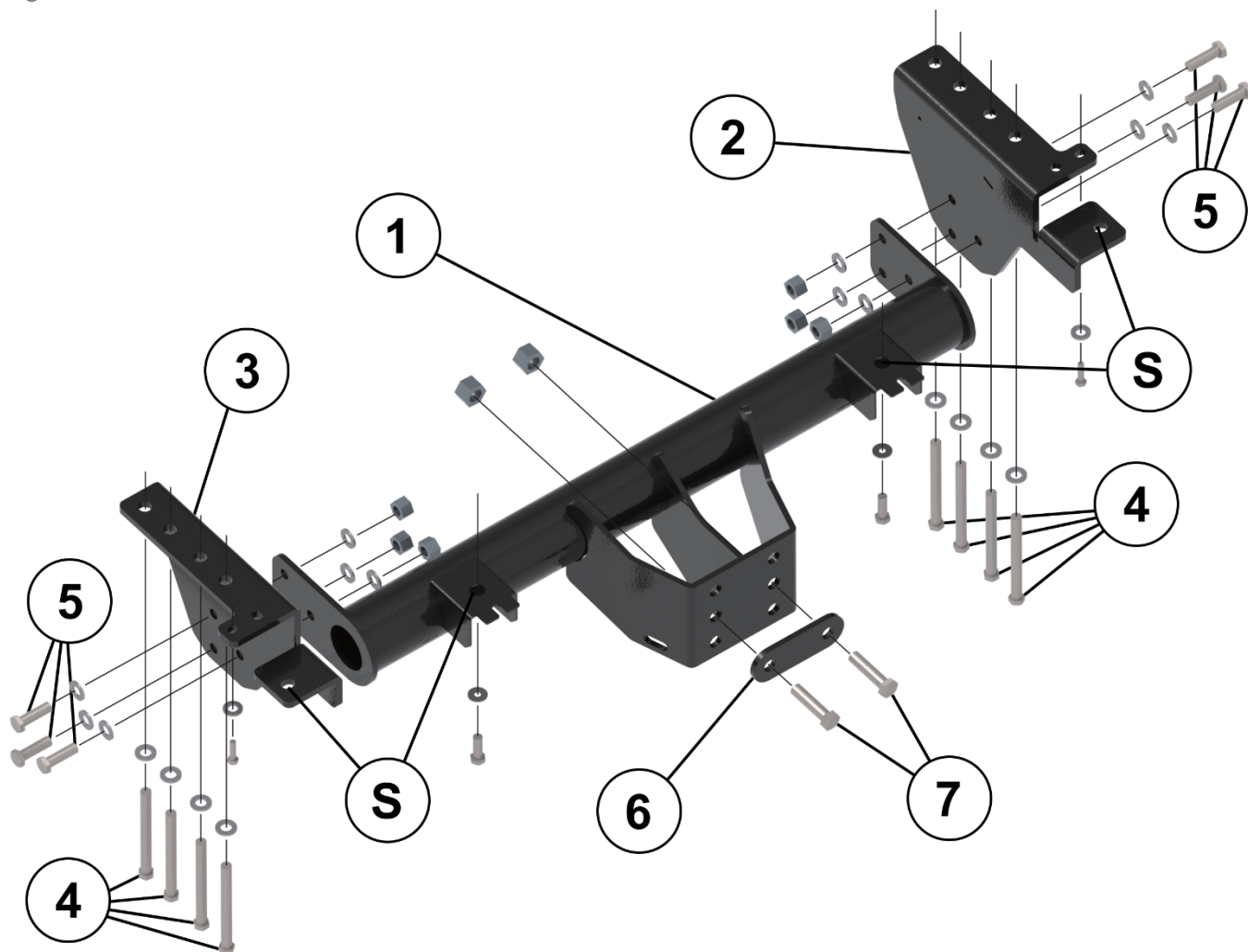

Fitting:

1. **Remove the bumper** by unscrewing the 4 retaining screws (S) (You will need these later to re-fit the bumper). Carefully unclip the wiring harness and remove the bumper from it's support frame.
2. Remove the bumper support frame.
3. Loosely attach sidearms (2) & (3) to the chassis using bolts (4) – **Do not fully tighten yet.**
4. Loosely attach crossbar (1) to sidearms (2) & (3) using bolts (5) – **Do not fully tighten yet.**
5. Re-fit the bumper using the original screws (S).
6. Fit coupling packer (6) and Towball using bolts (7).
7. Fully tighten all bolts to recommended torque settings (See above).

Note: This towbar must be used with a Class A50-1 or A50-X towball, which dimensionally conforms to A50-1 with a 'D' & 'S' value greater than or equal to that of the towbar.

****Manufacturers towing limits must be observed for towing capacity****