

Parts List:

Part No:	Description:	Size:	Torque	Qty:
1	Cross Bar			1
2	Sidearms			2
3	6 x Bolt, 4 x Nut, 4 x Lock Washer, 5 x Flat Washer (340mm O.D).	M12 x 1.75 x 100		
4	Towball Bolt + Lock Washer + Nut	M16 x 2.0 x 55	214Nm	2
5	Electrical Plate			1
6	6 x Bolt + 2 x Lock Washer + 2 x Flat Washer + 4 x Nut	M12 x 1.75 x 35		

Fitting:

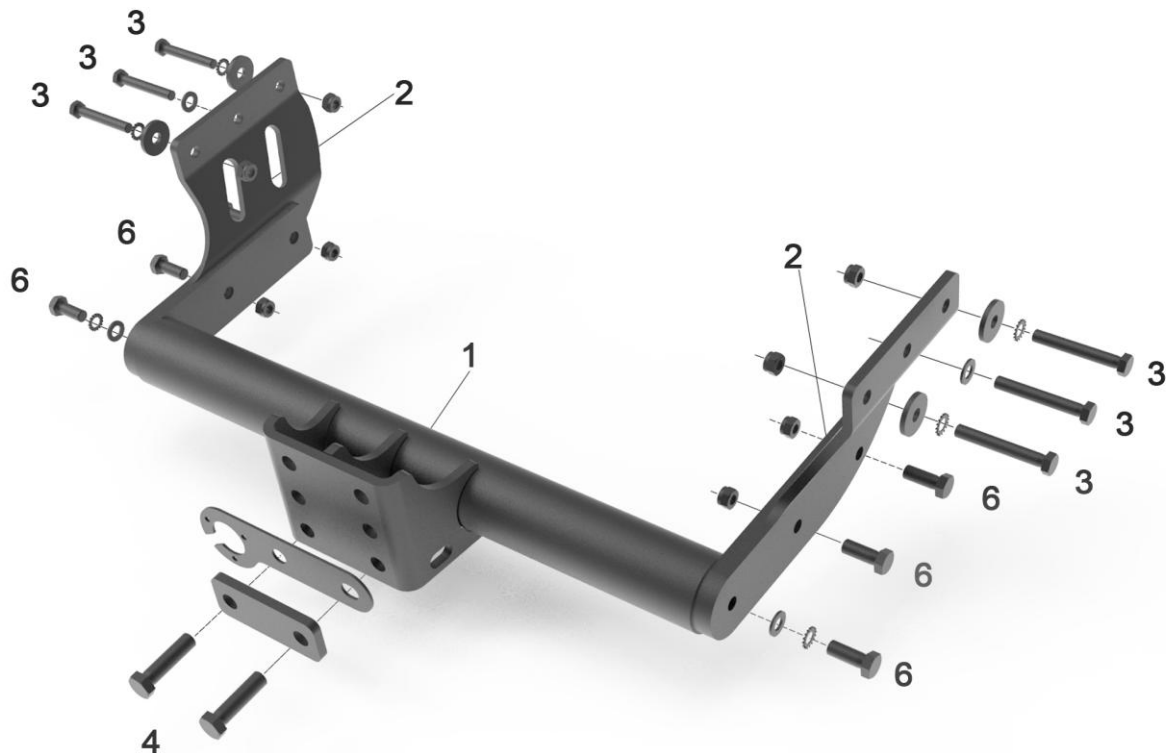

Fitting:

1. Remove the bolts securing the bumper supports to the chassis rail (On certain vehicles, these are only present on the left hand side).
2. Attach, but do not secure, the sidearms (2) to the chassis rails using bolts (3). (Where no bumper arm is fitted to the right hand side, use extra nuts and washers as show in the diagram above).
3. Attach, but not secure, the crossbar (1) to the sidearms (2) using bolts (6).
4. Tighten all bolts to the recommended torque vales (See table above).

Note: This towbar must be used with a Class A50-1 or A50-X towball, which dimensionally conforms to A50-1 with a 'D' & 'S' value greater than or equal to that of the towbar.

****Manufacturers towing limits must be observed for towing capacity****