

Parts List:

Part No:	Description:	Size:	Torque	Qty:
1	Crossbar			1
2	L/H Sidearm			1
3	R/H Sidearm			1
4	Bolt + Washer	M12 x 45 x 1.75mm	95Nm	2
5	Bolt + Nyloc Nut	M12 x 45 x 1.75mm	95Nm	4
6	Nyloc Nut + Washer	M10 x 1.5mm	53Nm	4
7	Bolt + Lock Washer + Nut	M16 x 50 x 2.0mm	214Nm	2
8	Coupling Packer			1
9	Electrics plate			1

Fitting:

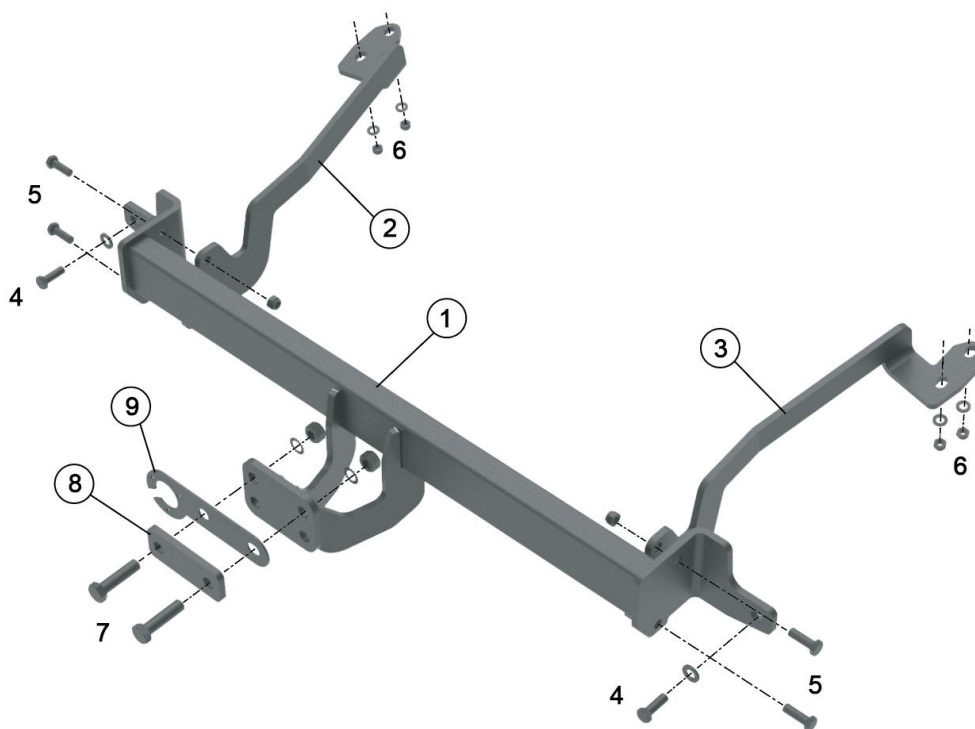

Fitting:

1. Remove the lower bumper edge fixings.
2. Remove the spare wheel.
3. If present, remove the nuts/bracket on the lower face of each chassis rail.
4. Remove the bottom bolt connecting the crash beam to the rear panel on each side.
5. Insert Crossbar (1) into the bumper cavity and attach, but do not secure, it to the existing holes using bolts (4)
6. Position Sidearms (2) & (3) over the existing studs on the lower side of the chassis rail and attach, but do not secure, using bolts (6). .
7. Attach, but do not secure sidearms (2) & (3) to crossbar (1) using bolts (5).
8. Check towbar is correctly aligned and then tighten all bolts to the recommended torque settings (See table above).
9. Re-fit the spare wheel.

Note: This towbar must be used with a Class A50-1 or A50-X towball, which dimensionally conforms to A50-1 with a 'D' & 'S' value greater than or equal to that of the towbar.

****Manufacturers towing limits must be observed for towing capacity****