



Fitting Instructions

TOWBAR SK31U
For Skoda Kodiah
2016-

MATERIALS

A	1	Main Assembly
B	2	Side Arm
C	2	M10 x 35 x 1.75 Bolts, Lock Washers, Flat Washers and Witter Cage Nuts. (Grade 10.9)
D	2	M10 x 35 x 1.75 Bolts, Lock Washers, Flat Washers and Nuts. (Grade 10.9)
E	4	M12 x 35 x 1.75 Bolts, Lock Washers, Flat Washers and Nuts.
SC	1	Safety Chain Plate Kit.
ZE	1	Retractable Electrical Plate.
ZN	1	Neck Option.

Note: This tow bar must be used with either a Witter tow ball (part number Z11) or Class A50-1 or A50-X tow ball, which dimensionally conforms to A50-1 with a 'D' and 'S' value greater than or equal to that of the tow bar.

FITTING

1. Remove bumper:
2. Remove fasteners from bottom edge and each wheel arch, unclip wheel arch trim, remove tip screw that is now exposed, remove plastic scuff / trim plate from top of bumper along bottom edge of tailgate and remove each corner screw. Pull bumper from off it's clips.
3. Remove crash beam and retain for customer.
4. Pre-assemble Witter Cage Nuts (C) to each Side Arm (B). Mount to opposite faces for each sidearm.
5. Remove tapes covering chassis mounting point holes and insert each Side Arms (B) into each chassis rail.
6. Loosely attach each Side Arm (B) to vehicle using fasteners (C & D).
7. Attach Crossbar (A) to Side Arms (B) using fixings (D).
8. **Fully Tighten All Fasteners**
9. Using the diagram below as a guide, cut bumper and refit to vehicle.
10. Attach Neck Option (ZN), Safety Chain Plate (SC) and Retractable Electrical Plate (ZE) to Cross Bar (A) using the respective kit instructions and fasteners.

Recommended torque settings:

Grade 8.8 bolts: M8 - 24Nm, M10 - 52 Nm, M12 - 80 Nm, M14 - 130 Nm, M16 - 200 Nm

Grade 10.9: M12 - 120Nm, M10 - 70Nm M8- 35Nm

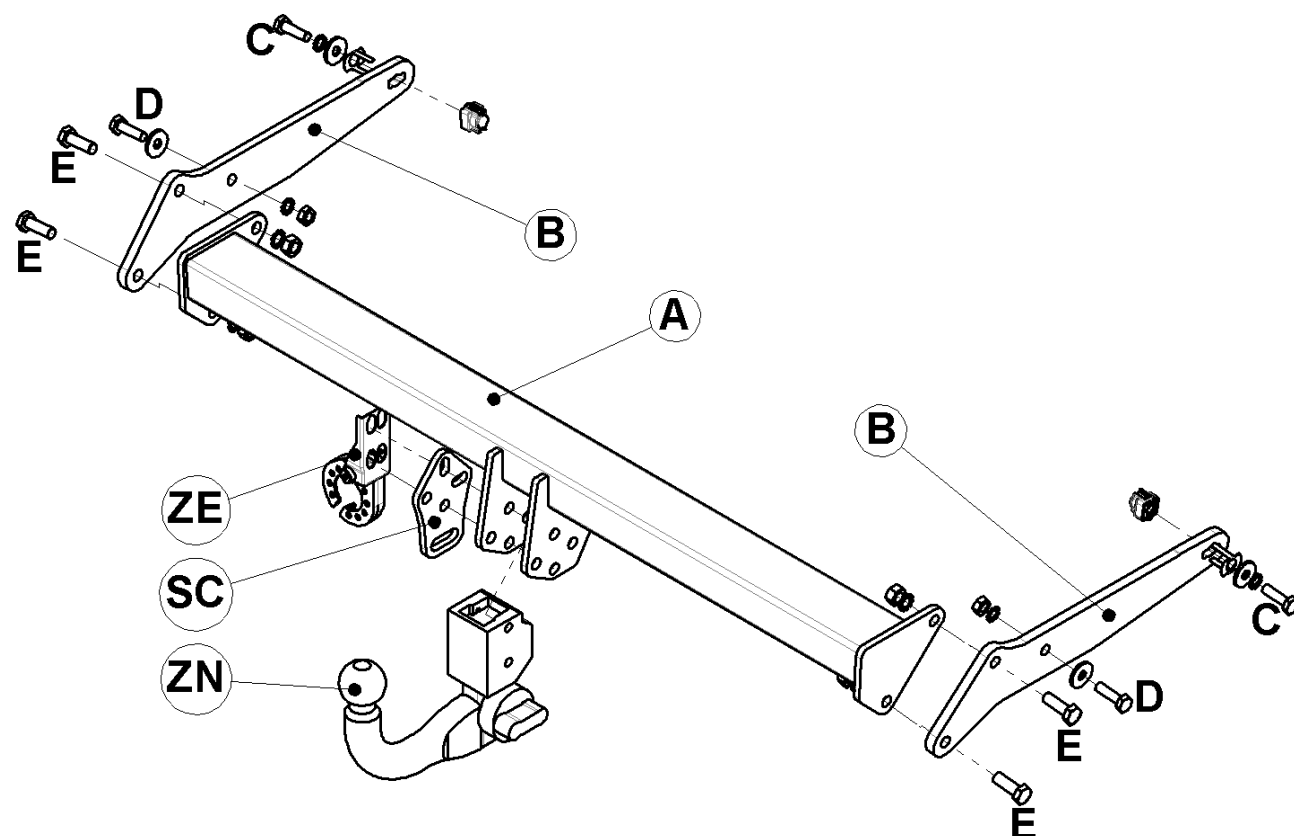

W 0001SK31U-FIT\$011701200000